



# Installation instructions

---

Sliding insect screen - version 1

Packaging content:

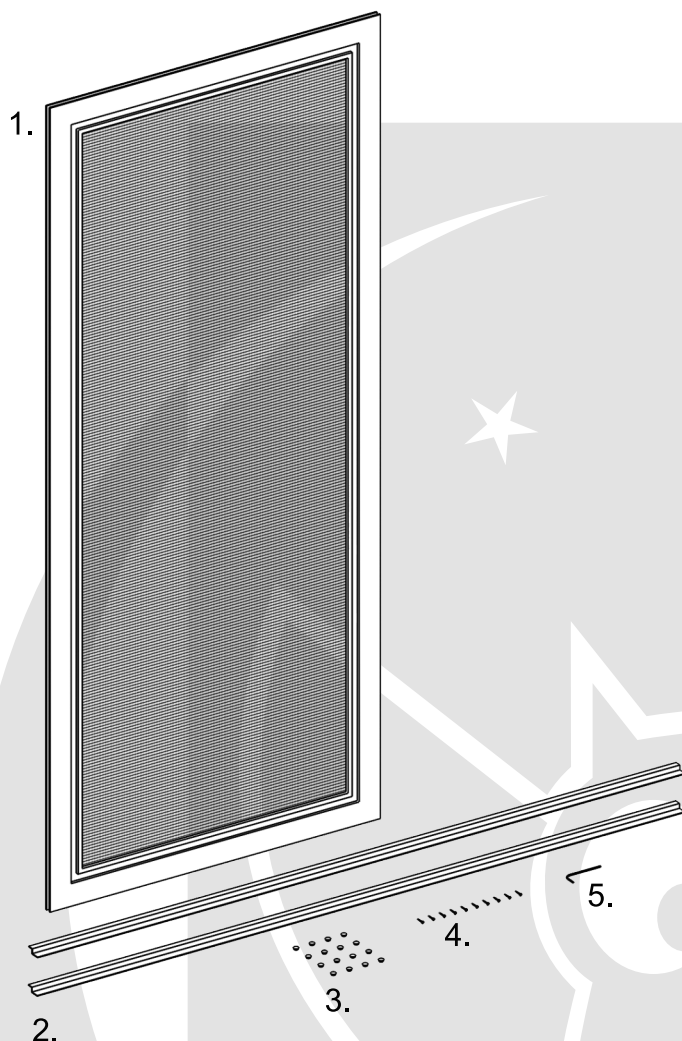

1. Insect screen.
  2. Side tracks.
  3. Side track caps.
  4. Screws (wall plugs\*)
  5. Allen key 2 mm.
- \* wall plugs – not included, use suitable wall plugs.

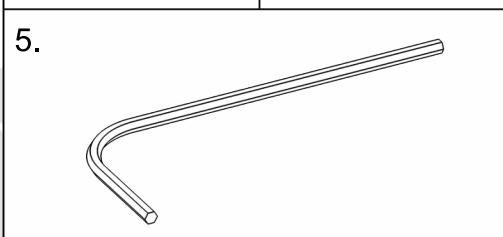
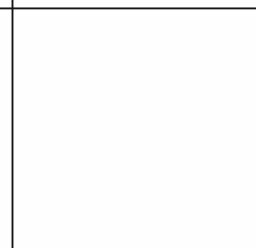
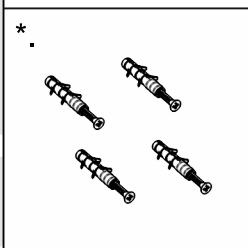
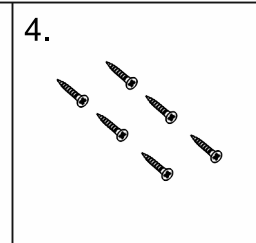
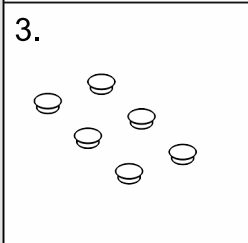

Dimensions given by placing the order:

- width of frame
- height of frame
- length of guides.

Guides. Depending on the selected configuration, the delivery may include:

– top:

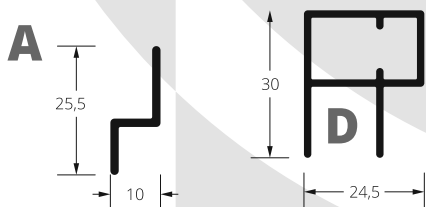

– bottom:

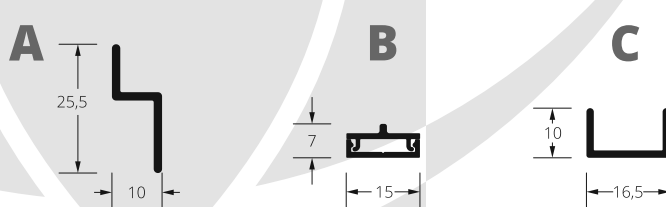

Example guides configuration:

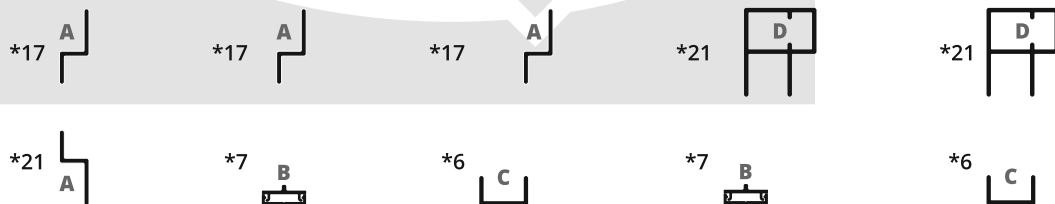

\* these are values that should be added to the height of the movable frame to obtain the total height of the insect screen in particular configurations of guides.

Fastening upper side tracks.

Side track A

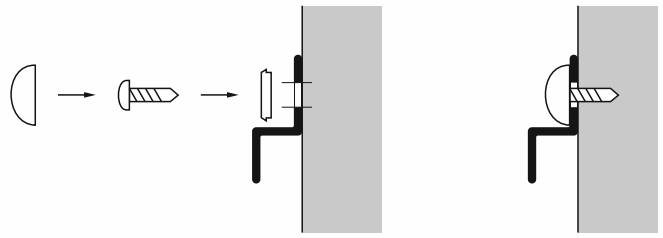

**A**

Side track D

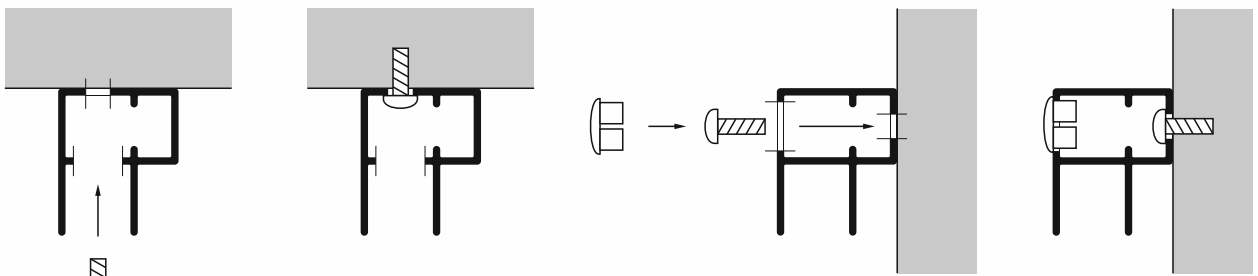

**D**

Fastening lower side tracks.

Side track A

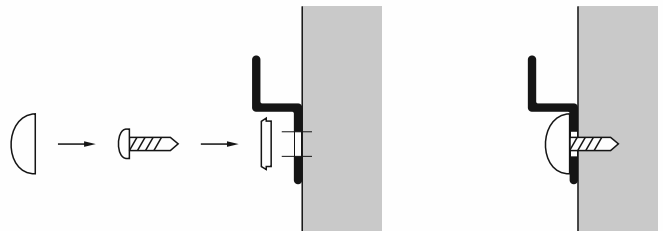

**A**

Side track B

**B**

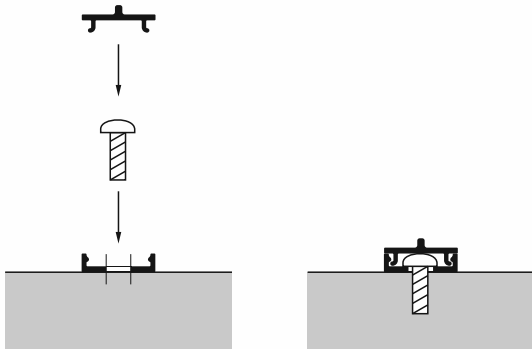

Side track C

**C**

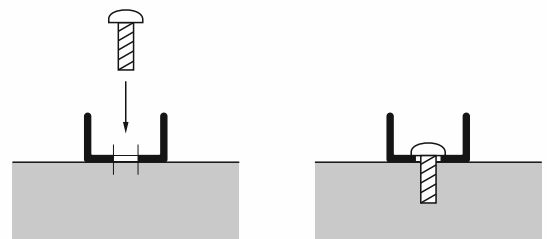

Fastening side tracks.

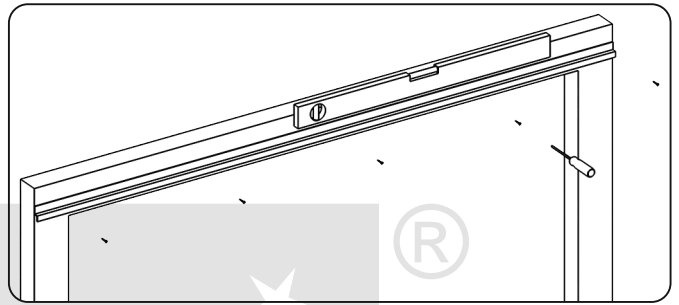
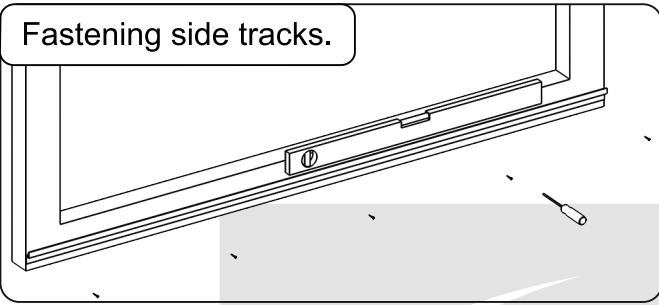

Installing insect screen.

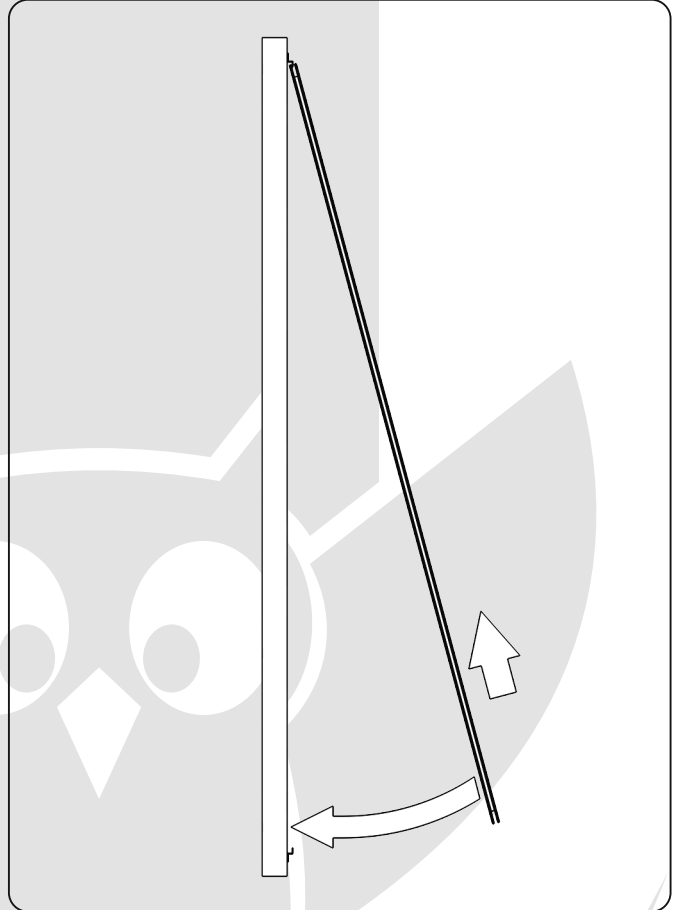
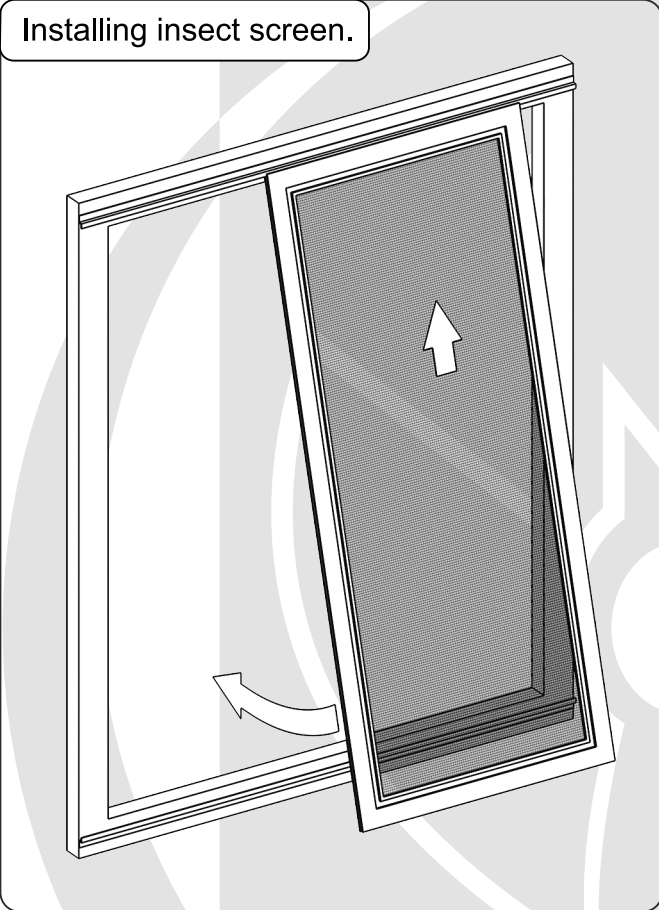

Locking insect screen.

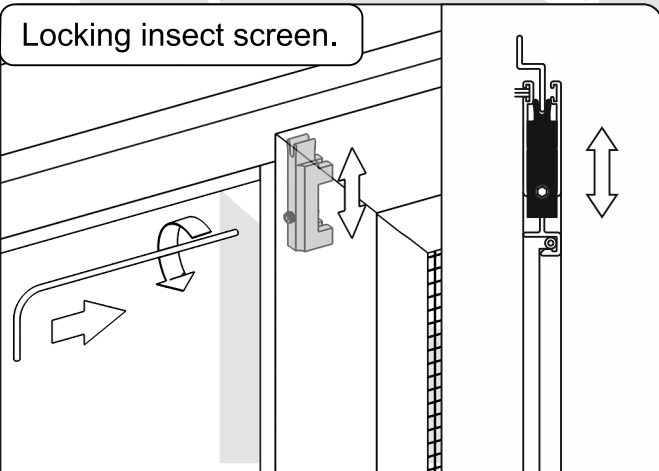

Lock the insect screen in side tracks using guide element (in top and bottom section of the frame). Keep minimum clearance in relation to the track.

Levelling insect screen.

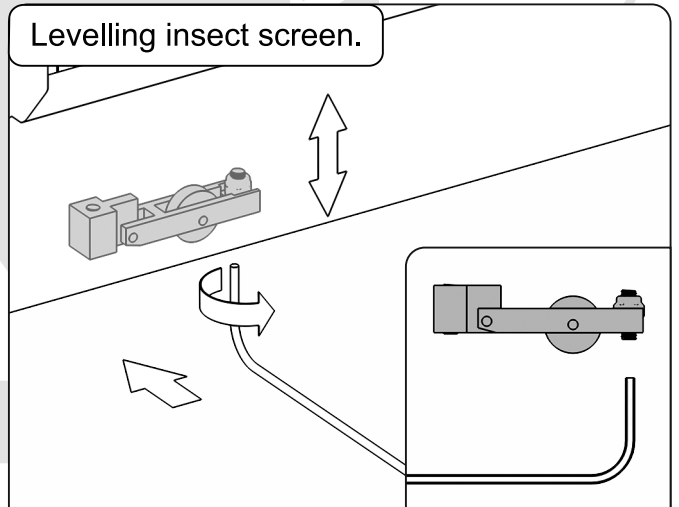

The insect screen inclination is adjusted with a set screw in the track roller with using 2 mm key.



Fart Produkt Sp. z o. o. Sp. k.  
ul. Towarowa 3, 87-100 Toruń  
tel. +48 56 623 55 77  
e-mail: [export@fartprodukt.pl](mailto:export@fartprodukt.pl)  
[www.fartprodukt.pl](http://www.fartprodukt.pl)