

# screen<sup>price list</sup>

edition 15.03.2023

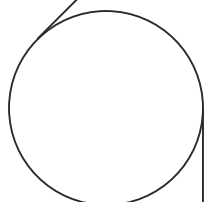

01 - 02 | **Product description**  
03 - 06 | **Building-over variants**  
07 - 09 | **Tables - technical data**

10 - 25 | **Premium system**

10 - 13 | **SCREEN 45°** or **90°** surface mounted, **ZIP SCREEN** guiding system  
14 - 17 | **SCREEN 45°** or **90°** surface mounting, side guidance - bottom beam in side guides  
18 - 21 | **SCREEN 45°** or **90°** surface mounting, side guidance - with cables - without guides  
22 - 25 | **SCREEN SKP** flush mounting, **ZIP SCREEN** guidance system

26 - 41 | **Standard system**

26 - 29 | **SCREEN 90°** in a extruded surface-mounted box, **ZIP SCREEN** guidance system  
30 - 33 | **SCREEN 90°** in a extruded surface-mounted box, side guidance - bottom beam in side guides  
34 - 37 | **SCREEN** in top-mounted box, **ZIP SCREEN** guidance system  
38 - 41 | **SCREEN** in top-mounted box, side guidance - bottom beam in side guides

42 - 29 | **Basic system**

42 - 45 | **SCREEN 90°** in a bent surface-mounted box, **ZIP SCREEN** guidance system  
46 - 49 | **SCREEN 90°** in a bent surface-mounted box, side guidance - bottom beam in side guides

50 - 53 | **Basic SPR system**

50 - 53 | **SCREEN 90°** in a bent surface-mounted box with spring control

54 - 55 | **Drives**

56 - 62 | **Order forms**

63 | **General terms of sale**



## Product description

Screen shields are a system that connects aesthetics and protection against excessive sunlight and heating of rooms, it allows you to protect the interior from the sun without losing natural lighting. Thanks to Screen shields, we are able to save on costs, e.g. air conditioning or artificial lighting, and by increasing the energy efficiency of the building, we can reduce operating expenses.

Screen covers will work both inside and outside the room. They will fit perfectly in apartments, houses, office buildings and other public buildings. Thanks to a wide range of fabrics and any color of the structure, Screen covers can be perfectly matched to many arrangements. Following the trend of increasing glazing dimensions, screen covers can be made up to 18 m<sup>2</sup> of area.

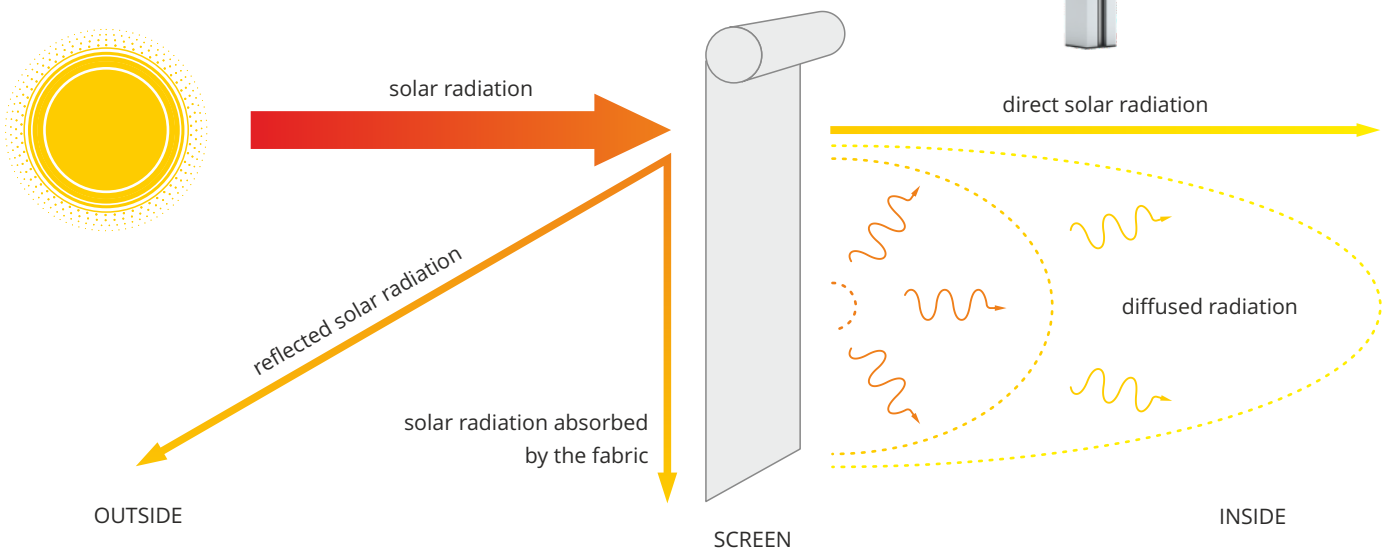

## Variants

Screen shields are available in three variants: premium, standard and basic, which differ in parameters to meet the needs of each user. They are available in three mounting options: surface-mounted (mounted on the façade or in the light of the window), flush-mounted and top-mounted. The system consists of four main elements: cassette, bottom beam, material and guides. There are 3 types of material guidance:

- Zip guidance - an innovative fabric fastening system that is integrated with the guides thanks to the Zip closure technology. This allows for perfect secure, tension and guidance of the fabric. The ZIP system allows for incredible stability and wind resistance. It can also act as a insect screen against insects (**Fig. 1**).
- Guidance with the bottom beam in the guides - the material does not enter into the guide, in which only the bottom beam is guided. There is free space between the material and the guide, thanks to which we obtain good air circulation. Recommended for use in places sheltered from strong wind (**Fig. 2**).
- Cable guidance - the material is attached to the bottom beam, which moves on cables without using of guides (**Fig. 3**). Cable guidance is only available in the premium system.



fig. 1.



fig. 2.



fig. 3.

## Properties of Fart Produkt Screen

- an effective method to protect the interior against excessive heating and solar radiation while maintaining natural lighting
- increasing the energetic efficiency of the building
- cassette and guides made of extruded aluminum
- resistance to weather conditions
- maximum width of 6 meters
- hidden fixings thanks to two-piece guides
- high quality – long useful life
- variety of structural solutions
- the possibility of complete building-over of the side guide
- a wide range of structure and fabrics colours
- fashionable element on the building facade
- work automation in cooperation with the weather automatics system.



## Fabrics

- high-quality fabrics made of plastics (glass fiber, PVC) from the best European producers guarantee resistance to weather conditions and a long useful life
- fabrics from different production batches may slightly differ in tone
- in the ZIP system, the material may be wavy in place of joining the zipper with the material. This effect may be intensified at low temperatures
- using cable guidance, the fabric may be bended due to long-standing winding
- **gabletop** - if the height and width of the blind with the selected material exceeds the width of the beam, it is necessary to perform a gabletop (joining 2 pieces of fabric), which is made on heat. This method results in a sharp standing out of the connection area. Doubling the material at the connection area causes uneven light transmission.

## Construction colours

Standard colours of the structure differ depending on the selected system, on special request we lacquer elements in any chosen colour from the RAL palette, but this involves an extended lead time and an additional charge.

1 shield in a 1 box

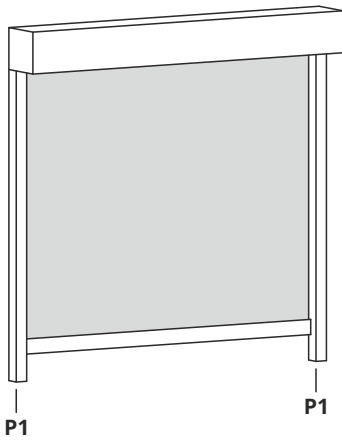

2 shields in a 1 box

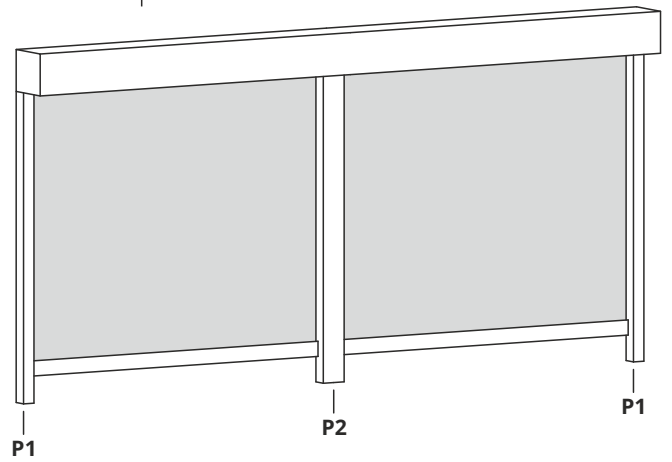

3 shields in a 1 box

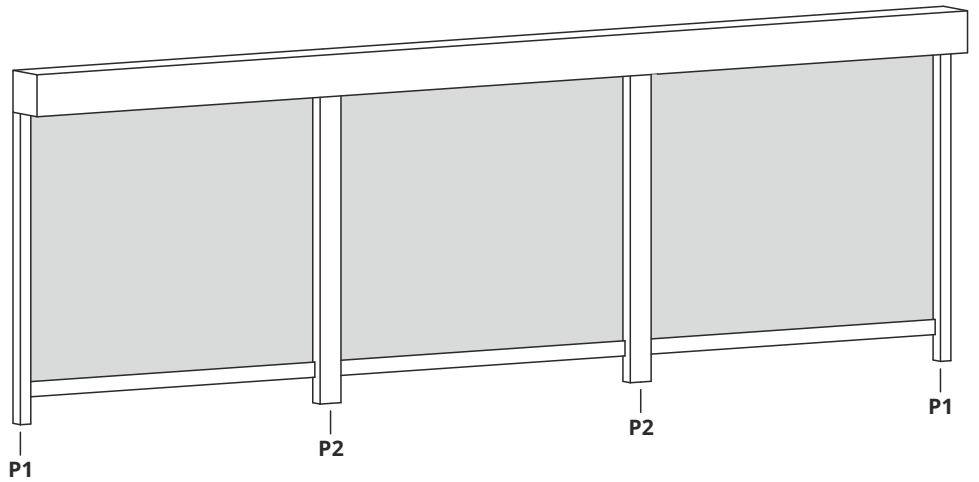

2 shields of different heights in a 1 box

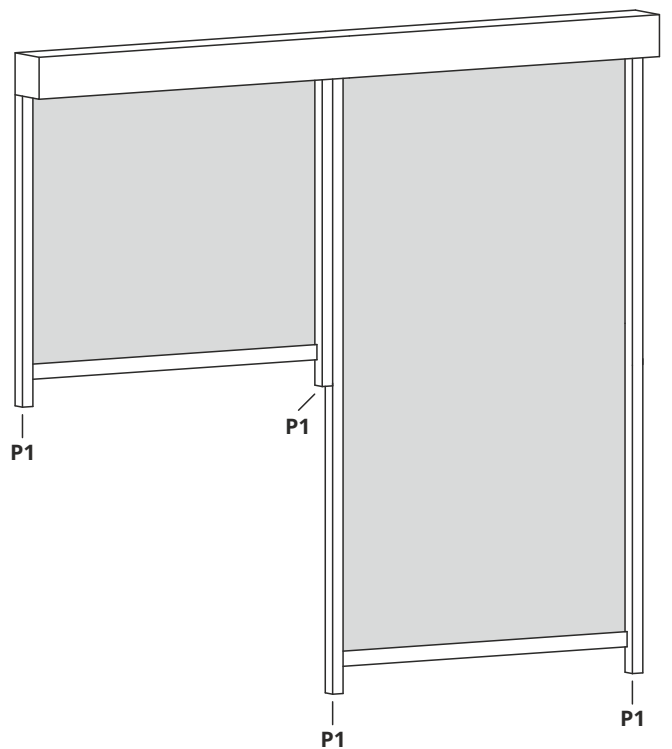

**Premium system – side guides** (in 2-pieces guides – with gray colour the end-cap has been marked)

**Premium system, ZIP guidance, surface mounting.**

**P1 single side guide**

Standard side guide

**P2 double side guide**

PD side guide

**Premium system, ZIP guidance, flush mounting, partly building-over of the side guides.**

**P1 single side guide**

**P2 double side guide**

**Premium system, ZIP guidance, flush mounting, completely building-over of the side guides** (attention – no double side guide, the set is connected by two single guides).

**P1 single side guide**

**P2 two side guides P1**

**Premium system, side guidance - bottom beam in side guides** (attention – no double side guide, the set is connected by two single guides).

**P1 single side guide**

**P2 two side guides P1**

**Standard system – side guides** (in 2-pieces guides – with gray colour the end-cap has been marked)

**Standard system** in a extruded surface-mounted box, **ZIP guidance.**

**P1** single side guide

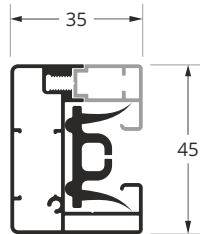

**P2** double side guide

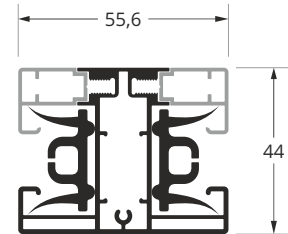

**Standard system** in a extruded surface-mounted box, side guidance - bottom beam in side guides.

**P1** single side guide

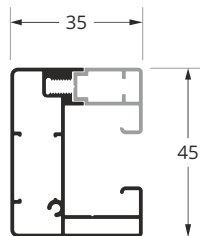

**P2** double side guide

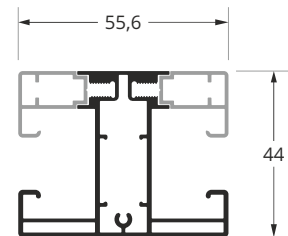

**Standard system** in top-mounted recessed box, **ZIP guidance.**

**P1** single side guide

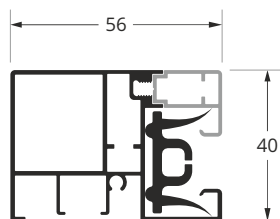

**P2** double side guide

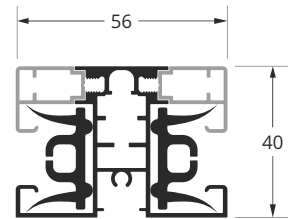

**Standard system** in top-mounted recessed box, side guidance - bottom beam in side guides.

**P1** single side guide

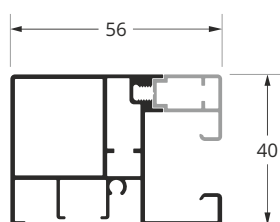

**P2** double side guide

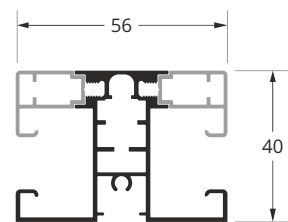

**Basic systems – side guides** (in 2-pieces guides – with gray colour the end-cap has been marked)

**Basic system** in a bent surface-mounted box, **ZIP guidance**.

**P1** single side guide

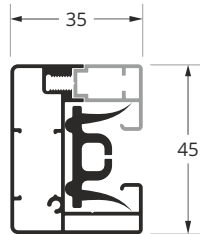

**P2** up touble side guide

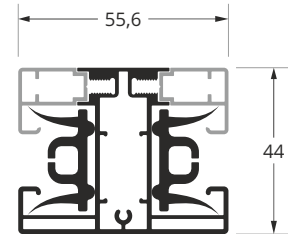

**Basic system** in a bent surface-mounted box, side guidance - bottom beam in side guides.

**P1** single side guide

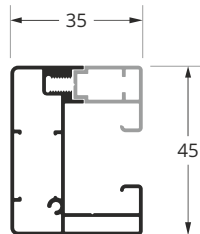

**P2** up touble side guide

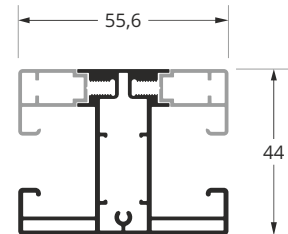

**Basic SPR system** in a bent surface-mounted box with spring control  
(attention – no double side guide, the set is connected by two single guides).

**P1** single side guide

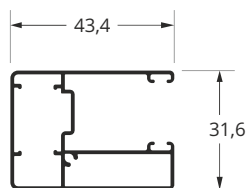

**P2** two side guides **P1**

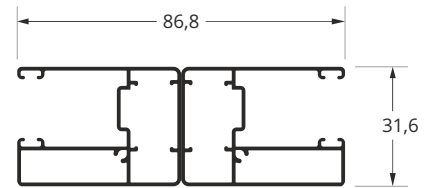



### Choice of the surface-mounted Premium cassette height (in mm) to the size of the shield

up to	1000	1500	2000	2500	3000	3500	4000	4500	5000	5500	6000
1000	85	85	85	85	85	125	125	125	125	125	125
1500	85	85	85	85	85	125	125	125	125	125	125
2000	95	95	95	95	95	125	125	125	125	125	125
2500	95	95	95	95	95	125	125	125	125	125	125
3000	95	95	95	95	95	125	125	125	125	125	125
3500	125	125	125	125	125	125	125	125	125	125	125
4000	125	125	125	125	125	125	125	125	125	125	125
4500	125	125	125	125	125	125	125	125	125	125	125
5000	125	125	125	125	125	125	125	125	125	125	125

↑ height (mm)



### Choice of the flush-mounted Premium cassette height (in mm) to the size of the shield

up to	1000	1500	2000	2500	3000	3500	4000	4500	5000
1000	105	105	105	105	105	105	105	125	125
1500	105	105	105	105	105	105	105	125	125
2000	105	105	105	105	105	105	105	125	125
2500	105	105	105	105	105	105	105	125	125
3000	105	105	105	105	105	105	105	125	125
3500	105	105	105	105	105	105	105	125	125
4000	125	125	125	125	125	125	125	125	125
4500	125	125	125	125	125	125	125	125	125
5000	125	125	125	125	125	125	125	125	125

↑ height (mm)



### System weight in kg (standard bottom beam)

up to	1000	1500	2000	2500	3000	3500	4000	4500	5000	5500	6000
1000	12	15	19	22	26	33	36	41	44	-	-
1500	13	16	20	24	27	35	38	43	46	-	-
2000	14	17	22	25	29	37	40	45	49	-	-
2500	15	19	23	27	31	39	42	48	51	-	-
3000	16	20	25	26	33	41	44	50	54	-	-
3500	18	22	26	28	34	43	46	52	-	-	-
4000	19	24	27	32	36	44	48	-	-	-	-
4500	21	25	29	33	38	46	-	-	-	-	-
5000	22	26	30	35	39	-	-	-	-	-	-

↑ height (mm)

← width (mm)

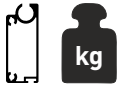

### System weight in kg (reinforced bottom beam)

up to	1000	1500	2000	2500	3000	3500	4000	4500	5000	5500	6000
1000	15	19	19	22	26	33	36	41	44	52	56
1500	16	20	20	24	27	35	38	43	46	55	59
2000	17	21	22	25	29	37	40	45	49	58	62
2500	18	23	23	27	31	39	42	48	51	61	64
3000	19	24	25	26	33	41	44	50	54	63	67
3500	21	26	26	28	34	43	46	52	-	-	-
4000	22	28	27	32	36	44	48	-	-	-	-
4500	24	29	29	33	38	46	-	-	-	-	-
5000	25	30	30	35	39	-	-	-	-	-	-

↑ height (mm)

← width (mm)



### Motor power [Nm] (standard bottom beam)

up to	1000	1500	2000	2500	3000	3500	4000	4500	5000	5500	6000
1000	6	6	6	8	8	10	10	15	15	-	-
1500	6	6	6	8	8	10	15	15	15	-	-
2000	6	6	6	8	10	10	15	15	15	-	-
2500	6	6	6	8	10	15	15	15	20	-	-
3000	6	6	8	10	15	15	15	15	20	-	-
3500	6	6	8	10	15	15	15	20	-	-	-
4000	6	6	8	10	15	15	20	-	-	-	-
4500	6	6	8	10	15	20	-	-	-	-	-
5000	6	6	8	10	15	-	-	-	-	-	-

↑ height (mm)

← width (mm)

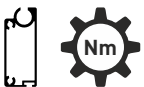

### Motor power [Nm] (reinforced bottom beam)

up to	1000	1500	2000	2500	3000	3500	4000	4500	5000	5500	6000
1000	6	6	6	8	8	10	10	15	15	15	15
1500	6	6	6	8	8	10	15	15	15	15	20
2000	6	6	6	8	10	10	15	15	15	20	20
2500	6	6	6	8	10	15	15	15	20	20	20
3000	6	8	8	10	15	15	15	15	20	20	20
3500	6	8	8	10	15	15	15	20	-	-	-
4000	6	8	8	10	15	15	20	-	-	-	-
4500	6	8	8	10	15	20	-	-	-	-	-
5000	6	8	8	10	15	-	-	-	-	-	-

↑ height (mm)

← width (mm)



← width (mm)

Choice of the winding shaft diameter (in mm) to the size of the shield												
up to	1000	1500	2000	2500	3000	3500	4000	4500	5000	5500	6000	
1000	63	63	63	63	63	63	78	85	85	85	100	100
1500	63	63	63	63	63	63	78	85	85	85	100	100
2000	63	63	63	63	63	63	78	85	85	85	100	100
2500	63	63	63	63	63	63	78	85	85	85	100	100
3000	63	63	63	63	63	63	78	85	85	85	100	100
3500	78	78	78	78	78	78	78	85	85			
4000	78	78	78	78	78	78	78	85				
4500	78	78	78	78	78	78	78					
5000	78	78	78	78	78	78						

height (mm) ↑

← width (mm)

Choice of the cassette height (in mm) to the size of the shield											
up to	1000	1500	2000	2500	3000	3200	3400	3600	3800	4000	
1000	85	85	85	85	85	100	100	100	100	100	
1700	85	85	85	85	85	100	100	100	100	100	
2000	100	100	100	100	100	100	100	100	100	100	
2200	100	100	100	100	100	100	100	100	100	100	
2500	100	100	100	100	100	120	120	120	120	120	
4000	100	100	100	100	100	120	120	120			
4200	100	100	100	100	100	120	120				
4500	100	100	100	100	100	120					
4700	100	100	100	100	100						
5000	100	100	100	100	100						

height (mm) ↑

← width (mm)

Motor power [Nm]								
up to	1000	1500	2000	2500	3000	3500	4000	
1000	6	6	6	10	10	10	10	
1400	6	6	6	10	10	10	10	
1800	6	6	6	10	10	10	15	
2200	6	6	6	10	10	10	15	
2600	6	10	10	10	10	10	15	
3000	6	10	10	10	10	15	15	
3400	6	10	10	10	10	15	15	
3800	6	10	10	10	15	15	15	
4200	6	10	10	10	15	15		
4600	6	10	10	10	15			
5000	6	10	10	10	15			

height (mm) ↑

← width (mm)

System weight in kg (*attention, the given weight is indicative)								
up to	1000	1500	2000	2500	3000	3500	4000	
1000	15	19	19	22	26	33	36	
1400	16	20	20	24	27	35	38	
1800	17	21	22	25	29	37	40	
2200	18	23	23	27	31	39	42	
2600	19	24	25	26	33	41	44	
3000	21	26	26	28	34	43	46	
3400	22	28	27	32	36	44	48	
3800	23	29	32	32	38	46	50	
4200	24	31	33	33	39	48		
4600	25	32	35	35	41			
5000	27	34	37	36	43			

height (mm) ↑

← width (mm)

Choice of the winding shaft diameter (in mm) to the size of the shield								
up to	1000	1500	2000	2500	3000	3500	4000	
1000	63	63	63	63	63	78	78	
1400	63	63	63	63	63	78	78	
1800	63	63	63	63	63	78	78	
2200	63	63	63	63	63	78	78	
2600	63	63	63	63	63	78	78	
3000	63	63	63	63	63	78	78	
3400	63	63	63	63	63	78	78	
3800	63	63	63	63	63	78	78	
4200	63	63	63	63	63	78		
4600	63	63	63	63	63			
5000	63	63	63	63	63			

height (mm) ↑

Wind speed test report

wind class	description	wind speed [km/h]	impact description on land
0	Calm	<1.85	No wind, smoke billowing upright.
1	Light Air	1.85-7.41	The direction of the wind is visible in the direction of smoke, there is no breeze.
2	Light breeze	7.41-12.96	The wind felt on face, the leaves lightly rocked.
3	Gentle wind	12.96-20.37	The leaves and twigs continue to sway.
4	Moderate wind	20.37-29.63	Dust and paper blowing, twigs and small branches sway.
5	Fresh breeze	29.63-40.74	Small trees sway, white foam in a sea water.
6	Strong wind	40.74-51.86	The big branches swayed, the sounds of the electric wire.
7	High wind	51.86-62.97	The whole tree rocked.
8	Gale	62.97-75.93	The branches of a broken tree, walking against a wind are quite heavy.
9	Severe Gale	75.93-88.90	The roof of the house is blown and thrown.
10	Strong storm	88.90-103.71	Trees are uprooted, houses are severely damaged.
11	Violent Storm	103.71-118.53	Storm damage large areas.
12	Hurricane force	>118.53	Big trees uprooted, houses collapsed.

Wind resistance class taking the dimensions into account (when using the ZIP guidance system)											
up to	1000	1500	2000	2500	3000	3500	4000	4500	5000	5500	6000
1000	11	11	11	11	9	9	9	9	9	8	8
1500	11	11	11	11	9	9	9	9	9	8	8
2000	11	11	11	11	9	9	9	9	9	8	8
2500	9	9	9	9	9	9	9	9	9	8	8
3000	9	9	9	9	9	9	9	9	9	8	8
3500	9	9	9	9	9	9	9	9	9		
4000	9	9	9	9	9	9	9				
4500	9	9	9	9	9	9					
5000	9	9	9	9	9						

height (mm) ↑

← width (mm)





**GUIDANCE SCHEME**

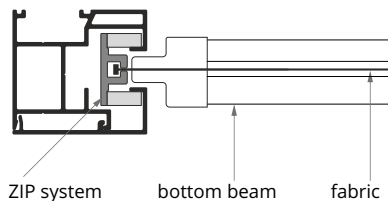

**CASSETTE**

- two types of cassettes to choose from: 45° and 90°, in three sizes: 85 mm, 95 mm and 125 mm.  
 - the maximum dimensions of shield for each of the cassette are given in a table on page 7<sup>th</sup>

**FABRIC**

- high-quality fabrics made of plastics (glass fiber, PVC) from the best European producers guarantee resistance to weather conditions and a long usefull life.

**ZIP SCREEN GUIDANCE**

- "ZIP SCREEN" guidance is an innovative way of guidance where the lower beam and material move inside the guides. This enables the perfect tension of the material, increases the resistance of the shield to difficult weather conditions, and additionally, when the shield is fully lowered, it fulfills a protective function, e.g. against dirt or insects.

**DRIVE**

- SCREEN Premium shields are offered only with an electric motor.  
 - the prices in the table do not include the price of the electric motor, it should be added. Price list of available drives on pages 32 - 33.

**COLOURS**

- standard colours are: white RAL 9016, crème RAL 9001, silver RAL 9006, brown RAL 8014, anthracite RAL 7016, black gray RAL 7021.  
 - on special order and at an additional charge, it is possible to varnish the product in any colour from the RAL palette (longer lead time).  
 - fabrics - according to the current pattern book.

**SIDE GUIDES**

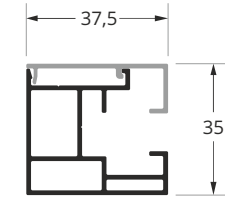

Standard side guide

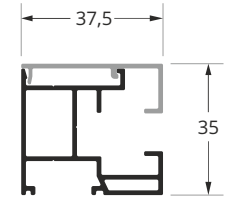

PD side guide

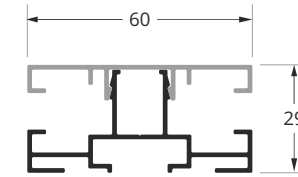

dwustronna

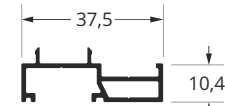

distance profile for PD side guides (note! only for single covers, cannot be used for sets)

**STANDARD BOTTOM BEAM**

From 1 m up to 5 m.

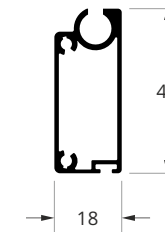

**REINFORCED BOTTOM BEAM**

From 0 up to 1 m.  
 From 5 m up to 6 m.

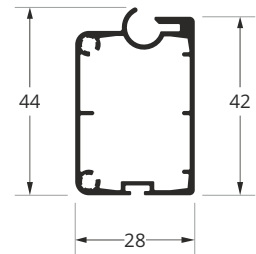

**CASSETTES 45°**

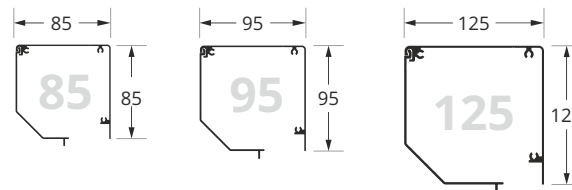

**CASSETTES 90°**

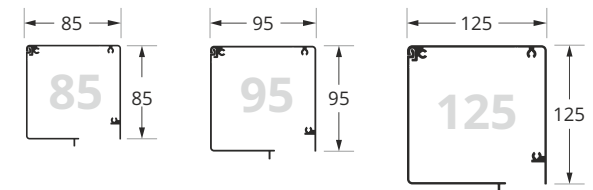

Premium system. SCREEN in 45° or 90° 125 mm cassette, ZIP SCREEN guiding system

up to	1000	1200	1400	1600	1800	2000	2200	2400	2600	2800	3000	3200	3400	3600	3800	4000	4200	4400	4600	4800	5000	5200	5400	5600	5800	6000
1000	333	369	404	440	476	511	551	586	622	658	693	733	768	804	839	875	915	950	986	1022	1057	1093	1129	1164	1200	1236
1200	351	388	424	461	498	534	575	612	648	685	722	762	799	836	872	909	950	986	1023	1059	1097	1134	1171	1209	1246	1283
1500	377	415	454	492	530	568	610	649	687	725	764	806	844	882	921	959	1001	1039	1077	1116	1154	1193	1231	1270	1308	1347
1700	395	434	473	513	552	592	635	674	713	753	792	835	875	914	954	993	1036	1075	1115	1154	1193	1233	1273	1312	1352	1391
2000	421	462	503	544	585	626	671	711	752	793	834	879	920	961	1002	1043	1087	1128	1169	1210	1251	1292	1333	1373	1414	1455
2200	439	481	523	565	607	649	695	737	779	821	863	908	950	992	1034	1076	1122	1164	1206	1248	1290	1332	1374	1415	1457	1499
2500	465	508	552	596	639	683	730	774	818	861	905	952	996	1039	1083	1127	1174	1217	1261	1305	1348	1392	1436	1480	1523	1567
2700	483	528	572	617	662	706	755	799	844	889	933	981	1026	1071	1116	1160	1208	1253	1298	1342	1387	1432	1477	1522	1568	1613
3000	509	555	602	648	694	740	790	837	883	929	975	1025	1072	1118	1164	1210	1260	1306	1352	1399	1445	1491	1537	1583	1629	1675
3200	527	574	622	669	716	764	814	862	909	956	1003	1055	1102	1149	1197	1244	1295	1342								
3500	553	602	651	700	749	798	850	899	948	997	1046	1098	1147	1196	1245	1294	1346									
3700	571	621	671	721	771	821	875	924	974	1024	1074	1128	1178	1228	1278	1327										
4000	597	649	700	752	803	855	910	962	1013	1064	1116	1171	1223	1274												
4200	615	668	720	773	826	878	934	987	1039	1092	1144	1201	1254													
4500	641	695	750	804	858	912	970	1024	1078	1132	1187	1244														
4700	659	714	770	825	880	935	994	1049	1104	1160	1215															
5000	685	742	799	856	912	969	1030	1087	1143	1200	1257															

Premium system. SCREEN in 45° or 90° 85/95 mm cassette, ZIP SCREEN guiding system

up to	1000	1200	1400	1600	1800	2000	2200	2400	2600	2800	3000
1000	259	285	310	336	361	387	412	437	463	489	514
1200	277	304	330	357	384	410	436	463	489	516	543
1500	303	331	359	388	416	444	472	500	528	556	585
1700	321	351	380	409	438	467	497	525	555	584	613
2000	347	378	409	440	470	502	532	563	593	625	655
2200	365	397	429	461	492	525	556	588	620	652	684
2500	392	425	458	492	525	559	592	625	659	692	725
2700	409	444	478	513	547	582	616	650	685	720	754
3000	436	471	508	544	580	616	652	688	724	760	796

Remarks and surcharges

- net prices - TAX should be added.
- standard colours: white RAL 9016, crème RAL 9001, silver RAL 9006, brown RAL 8014, anthracite RAL 7016, black gray RAL 7021.
- for an additional fee, varnishing in any colour from the RAL palette possible (extended lead time).

- BOX varnishing in RAL colour 22,00 € / pc.
- guides varnishing in RAL colour 13,75 € / set
- bottom beam varnishing in RAL colour 8,25 € / pc.

Premium system. SCREEN in 45° or 90° 125 mm cassette, ZIP SCREEN guiding system

up to	1000	1200	1400	1600	1800	2000	2200	2400	2600	2800	3000	3200	3400	3600	3800	4000	4200	4400	4600	4800	5000	5200	5400	5600	5800	6000
1000	339	376	413	450	487	523	564	601	638	675	712	752	789	826	863	900	940	977	1014	1051	1088	1125	1162	1199	1236	1272
1200	358	397	434	473	511	549	591	629	667	705	744	785	824	862	900	938	980	1019	1057	1095	1133	1172	1211	1250	1288	1327
1500	386	426	466	506	547	587	631	671	711	751	791	835	875	915	956	996	1040	1080	1120	1160	1200	1240	1281	1321	1361	1402
1700	405	447	488	530	571	612	658	699	740	782	823	868	910	951	993	1034	1080	1121	1162	1204	1245	1287	1329	1370	1412	1453
2000	433	477	520	563	607	650	698	741	784	828	871	918	961	1005	1048	1092	1139	1182	1226	1269	1312	1355	1399	1442	1485	1528
2200	452	497	542	586	631	676	724	769	814	859	903	951	996	1041	1086	1130	1179	1223	1268	1313	1357	1402	1446	1491	1535	1580
2500	480	527	574	620	667	714	764	811	857	904	951	1001	1048	1094	1141	1188	1238	1285	1331	1378	1425	1472	1518	1565	1612	1659
2700	499	547	595	643	691	739	791	839	887	935	983	1034	1082	1130	1178	1226	1278	1326	1374	1421	1470	1518	1567	1615	1663	1712
3000	527	577	627	677	727	777	830	881	931	980	1030	1084	1134	1184	1233	1283	1337	1387	1437	1487	1537	1586	1636	1686	1735	1785
3200	547	597	649	700	751	803	857	908	960	1011	1062	1117	1168	1220	1271	1322	1377	1428								
3500	574	628	681	734	787	840	897	951	1003	1057	1110	1167	1220	1273	1326	1379	1436									
3700	593	648	703	757	811	866	924	978	1033	1087	1142	1200	1255	1309	1363	1418										
4000	622	678	734	791	847	904	964	1020	1077	1133	1189	1250	1306	1362												
4200	641	699	756	814	872	930	991	1048	1106	1164	1221	1283	1341													
4500	669	728	788	848	907	967	1030	1090	1150	1209	1269	1332														
4700	688	749	810	871	932	993	1057	1118	1179	1240	1302															
5000	716	778	842	905	967	1030	1097	1160	1223	1286	1349															

Premium system. SCREEN in 45° or 90° 85/95 mm cassette, ZIP SCREEN guiding system

up to	1000	1200	1400	1600	1800	2000	2200	2400	2600	2800	3000
1000	265	293	319	346	372	399	426	452	479	506	532
1200	284	313	341	368	397	425	452	481	509	537	565
1500	313	342	372	402	432	462	492	522	552	582	612
1700	332	363	394	425	457	488	519	550	582	613	644
2000	360	393	426	459	492	526	559	592	625	659	692
2200	379	413	448	482	517	551	586	620	655	689	724
2500	407	443	480	516	553	589	625	662	699	735	771
2700	426	463	502	539	577	615	653	690	728	766	803
3000	454	493	533	573	613	652	692	732	771	811	851

Remarks and surcharges

- net prices - TAX should be added.
- standard colours: white RAL 9016, crème RAL 9001, silver RAL 9006, brown RAL 8014, anthracite RAL 7016, black gray RAL 7021.
- for an additional fee, varnishing in any colour from the RAL palette possible (extended lead time).

- BOX varnishing in RAL colour 22,00 € / pc.
- guides varnishing in RAL colour 13,75 € / set
- bottom beam varnishing in RAL colour 8,25 € / pc.

Premium system. SCREEN in 45° or 90° 125 mm cassette, ZIP SCREEN guiding system

up to	1000	1200	1400	1600	1800	2000	2200	2400	2600	2800	3000	3200	3400	3600	3800	4000	4200	4400	4600	4800	5000	5200	5400	5600	5800	6000
1000	359	400	440	481	522	563	608	648	689	730	771	815	856	897	938	979	1023	1064	1105	1146	1187	1228	1268	1309	1350	1391
1200	382	425	468	511	554	596	643	686	729	772	815	861	904	948	990	1033	1080	1123	1166	1208	1252	1295	1339	1382	1426	1469
1500	416	462	508	554	600	646	696	742	788	834	880	930	976	1022	1068	1114	1164	1210	1256	1302	1348	1395	1441	1487	1533	1580
1700	439	487	535	583	631	680	731	780	828	876	924	976	1024	1072	1121	1169	1221	1269	1317	1365	1413	1462	1510	1558	1607	1655
2000	472	524	575	627	678	729	785	836	887	938	990	1045	1096	1147	1199	1250	1305	1356	1408	1459	1510	1561	1612	1663	1714	1765
2200	496	549	602	656	709	763	820	873	927	980	1033	1091	1144	1197	1251	1304	1361	1414	1468	1522	1575	1628	1681	1734	1787	1841
2500	530	586	643	699	756	813	873	929	986	1042	1099	1159	1216	1272	1329	1385	1445	1502	1559	1615	1672	1729	1785	1842	1899	1955
2700	553	611	670	729	787	846	908	967	1026	1084	1143	1205	1264	1322	1381	1440	1502	1561	1619	1678	1737	1796	1855	1914	1973	2032
3000	587	648	710	772	834	896	961	1023	1085	1147	1208	1274	1336	1397	1459	1521	1586	1648	1710	1772	1833	1895	1956	2018	2079	2141
3200	610	673	738	801	865	929	997	1060	1124	1188	1252	1320	1384	1447	1511	1575	1643	1707								
3500	644	711	778	844	912	979	1050	1117	1183	1250	1317	1388	1455	1522	1589	1656	1727									
3700	666	736	805	874	943	1012	1085	1154	1223	1292	1361	1434	1503	1572	1641	1710										
4000	701	773	845	917	989	1062	1138	1210	1282	1354	1427	1503	1575	1647												
4200	724	798	873	947	1021	1096	1173	1248	1322	1396	1471	1549	1623													
4500	758	835	913	990	1067	1145	1226	1304	1381	1458	1536	1617														
4700	781	860	940	1019	1099	1179	1262	1341	1421	1500	1580															
5000	814	897	980	1063	1145	1228	1315	1397	1480	1563	1645															

Premium system. SCREEN in 45° or 90° 85/95 mm cassette, ZIP SCREEN guiding system

up to	1000	1200	1400	1600	1800	2000	2200	2400	2600	2800	3000
1000	285	316	347	377	408	438	469	500	531	561	592
1200	308	341	374	406	439	472	505	538	570	603	636
1500	342	378	414	450	486	522	558	593	629	665	701
1700	365	404	441	479	517	555	593	631	669	707	745
2000	399	440	481	523	564	605	646	687	728	770	810
2200	422	465	509	552	595	638	681	725	768	811	854
2500	456	503	549	595	641	688	734	781	827	873	919
2700	479	527	576	625	673	722	770	818	867	915	964
3000	513	565	616	668	719	771	823	874	926	977	1029

Remarks and surcharges

- net prices - TAX should be added.
- standard colours: white RAL 9016, crème RAL 9001, silver RAL 9006, brown RAL 8014, anthracite RAL 7016, black gray RAL 7021.
- for an additional fee, varnishing in any colour from the RAL palette possible (extended lead time).

- BOX varnishing in RAL colour 22,00 € / pc.
- guides varnishing in RAL colour 13,75 € / set
- bottom beam varnishing in RAL colour 8,25 € / pc.



**GUIDANCE SCHEME**

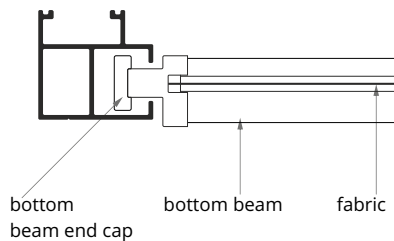

**CASSETTE**

- two types of cassettes to choose from: 45° and 90°, in three sizes: 85 mm, 95 mm and 125 mm.
- the maximum dimensions of shield for each of the cassette are given in a table on page 7<sup>th</sup>.

**FABRIC**

- high-quality fabrics made of plastics (glass fiber, PVC) from the best European producers guarantee resistance to weather conditions and a long useful life.

**GUIDANCE - BOTTOM BEAM IN SIDE GUIDES**

- bottom beam in side guides - the fabric is not recessed in the guides, only the bottom beam is guided inside them.

**DRIVE**

- SCREEN Premium shields are offered only with an electric motor.
- the prices in the table do not include the price of the electric motor, it should be added. Price list of available drives on pages 32 - 33.

**COLOURS**

- standard colours are: white RAL 9016, crème RAL 9001, silver RAL 9006, brown RAL 8014, anthracite RAL 7016, black gray RAL 7021.
- on special order and at an additional charge, it is possible to varnish the product in any colour from the RAL palette (longer lead time).
- fabrics - according to the current pattern book.

**SIDE GUIDES**

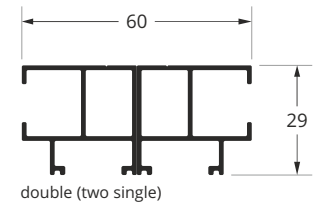
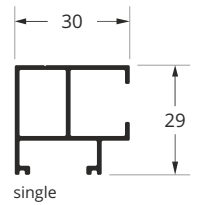

**STANDARD BOTTOM BEAM**

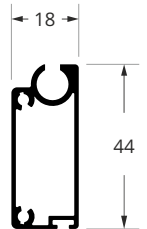

**CASSETTES 45°**

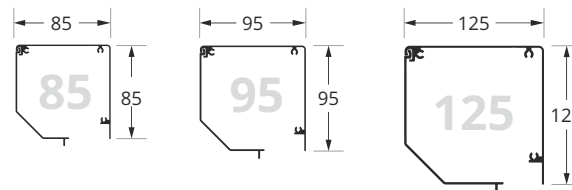

**CASSETTES 90°**

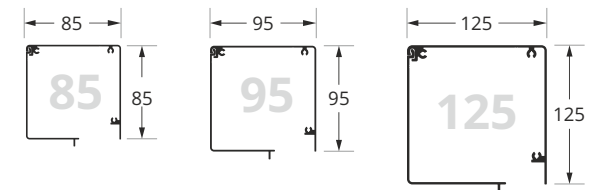



Premium system. SCREEN in 45° or 90° 125 mm cassette, side guidance - bottom beam in side guides

up to	1000	1200	1400	1600	1800	2000	2200	2400	2600	2800	3000	3200	3400	3600	3800	4000	4200	4400	4600	4800	5000
1000	304	340	376	412	447	483	522	558	593	629	665	704	739	775	811	847	886	922	958	993	1029
1200	316	352	389	426	463	500	540	577	613	650	687	727	764	801	838	874	915	951	988	1025	1062
1500	332	371	409	447	486	524	566	604	643	681	719	761	799	838	876	914	957	995	1033	1071	1110
1700	344	383	423	462	501	541	584	623	662	702	741	784	824	863	903	942	985	1024	1063	1103	1143
2000	361	402	443	483	524	565	610	651	692	733	774	818	859	900	941	982	1027	1068	1109	1149	1191
2200	372	414	456	498	540	582	627	670	712	754	796	842	884	926	968	1010	1055	1097	1139	1181	1223
2500	388	432	475	519	563	606	654	697	741	785	828	875	919	962	1006	1050	1097	1141	1184	1228	1271
2700	400	445	489	534	578	623	672	716	761	806	850	899	943	988	1032	1077	1125	1170	1215	1260	1304
3000	416	462	509	555	601	648	698	744	790	836	882	932	978	1025	1071	1117	1167	1214	1260	1306	1352
3200	428	475	523	570	617	665	715	763	810	857	905	956	1003	1050	1098	1145	1196	1243			
3500	445	494	542	591	640	689	742	790	839	888	937	990	1038	1087	1136	1185	1238				
3700	456	506	555	606	656	706	759	809	859	909	959	1013	1062	1113	1162	1212					
4000	472	524	575	627	678	730	785	837	888	940	991	1047	1098	1150							
4200	484	537	589	642	694	747	803	855	908	961	1013	1070	1122								
4500	500	554	609	663	717	772	829	883	937	992	1046	1104									
4700	512	567	622	678	733	788	847	902	958	1013	1068										
5000	528	585	642	699	756	812	873	930	987	1043	1100										

Premium system. SCREEN in 45° or 90° 85/95 mm cassette, side guidance - bottom beam in side guides

up to	1000	1200	1400	1600	1800	2000	2200	2400	2600	2800	3000
1000	219	244	269	295	321	346	371	397	422	448	473
1200	230	256	283	310	336	363	389	416	442	469	495
1500	247	274	303	331	359	387	415	443	471	500	528
1700	258	287	316	346	374	404	433	462	492	521	550
2000	275	305	336	367	397	428	459	490	521	551	582
2200	286	318	350	381	413	445	477	509	541	573	604
2500	302	336	369	403	436	470	503	536	570	603	637
2700	314	348	383	417	452	486	521	556	590	624	659
3000	330	366	403	439	475	511	547	583	619	655	691

**Remarks and surcharges**

- net prices - TAX should be added.
- standard colours: white RAL 9016, crème RAL 9001, silver RAL 9006, brown RAL 8014, anthracite RAL 7016, black gray RAL 7021.
- for an additional fee, varnishing in any colour from the RAL palette possible (extended lead time).

- BOX varnishing in RAL colour 22,00 € / pc.
- guides varnishing in RAL colour 13,75 € / set
- bottom beam varnishing in RAL colour 8,25 € / pc.

**Premium system. SCREEN in 45° or 90° 125 mm cassette, side guidance - bottom beam in side guides**

up to	1000	1200	1400	1600	1800	2000	2200	2400	2600	2800	3000	3200	3400	3600	3800	4000	4200	4400	4600	4800	5000
1000	310	347	384	421	458	495	536	573	609	646	683	724	760	797	834	872	912	949	986	1023	1060
1200	323	361	400	438	476	514	556	595	632	671	709	751	789	827	866	904	946	984	1022	1060	1098
1500	342	382	422	462	502	542	586	626	666	706	747	791	830	871	911	951	995	1035	1075	1115	1156
1700	354	396	437	479	520	561	607	648	689	731	772	818	859	900	942	983	1029	1070	1111	1153	1194
2000	373	416	460	503	546	590	636	680	724	767	810	857	901	944	988	1031	1078	1122	1165	1208	1252
2200	385	430	475	519	564	609	657	702	747	791	836	885	929	974	1019	1064	1112	1156	1201	1246	1291
2500	404	450	497	544	590	637	687	734	781	827	874	924	971	1017	1064	1111	1161	1208	1255	1302	1348
2700	417	464	512	560	608	656	708	756	803	852	900	951	999	1047	1095	1143	1195	1243	1291	1339	1386
3000	435	484	535	584	634	684	738	788	837	887	937	991	1041	1091	1141	1191	1244	1294	1344	1394	1444
3200	447	499	550	601	652	704	758	810	861	912	963	1018	1070	1120	1172	1223	1278	1329			
3500	466	519	572	625	679	732	789	842	895	948	1001	1058	1111	1164	1218	1271	1328				
3700	479	533	587	642	696	751	809	863	918	972	1027	1085	1139	1194	1248	1303					
4000	497	553	610	666	722	779	839	895	952	1008	1065	1125	1181	1238							
4200	510	567	625	683	740	798	860	917	975	1033	1090	1152	1210								
4500	528	587	647	707	767	827	890	949	1009	1069	1129	1192									
4700	541	602	662	724	784	846	910	971	1032	1093	1154										
5000	559	622	685	748	811	873	940	1003	1066	1129	1192										

**Premium system. SCREEN in 45° or 90° 85/95 mm cassette, side guidance - bottom beam in side guides**

up to	1000	1200	1400	1600	1800	2000	2200	2400	2600	2800	3000
1000	225	251	278	304	332	358	385	412	438	465	492
1200	237	265	294	321	349	378	405	433	462	489	517
1500	256	285	316	346	375	406	436	465	495	525	555
1700	269	300	331	362	393	425	456	487	519	550	581
2000	287	320	353	386	419	452	486	519	553	586	619
2200	300	334	368	403	438	472	506	541	576	610	645
2500	318	354	391	427	464	500	537	573	609	646	683
2700	330	368	406	444	482	519	557	595	633	670	708
3000	349	388	428	468	508	547	587	627	667	706	746

**Remarks and surcharges**

- net prices - TAX should be added.
- standard colours: white RAL 9016, crème RAL 9001, silver RAL 9006, brown RAL 8014, anthracite RAL 7016, black gray RAL 7021.
- for an additional fee, varnishing in any colour from the RAL palette possible (extended lead time).

BOX varnishing in RAL colour	22,00 € / pc.
guides varnishing in RAL colour	13,75 € / set
bottom beam varnishing in RAL colour	8,25 € / pc.

Premium system. SCREEN in 45° or 90° 125 mm cassette, side guidance - bottom beam in side guides

up to	1000	1200	1400	1600	1800	2000	2200	2400	2600	2800	3000	3200	3400	3600	3800	4000	4200	4400	4600	4800	5000
1000	330	371	412	453	493	534	579	620	661	701	742	787	827	869	909	951	995	1036	1077	1117	1159
1200	347	390	433	476	519	562	608	652	694	737	780	827	870	913	956	998	1045	1088	1131	1174	1217
1500	371	417	464	509	555	601	651	698	743	789	836	886	931	978	1024	1070	1120	1166	1212	1258	1304
1700	388	436	484	532	581	629	681	729	777	825	873	925	973	1021	1070	1118	1170	1218	1266	1314	1363
2000	412	464	515	566	617	669	723	775	827	878	929	984	1035	1086	1138	1189	1244	1296	1347	1398	1449
2200	429	482	535	589	643	696	753	806	860	913	966	1024	1077	1131	1184	1238	1294	1348	1401	1454	1508
2500	453	510	566	623	679	736	796	853	909	966	1022	1082	1139	1195	1252	1308	1369	1425	1482	1539	1595
2700	470	528	587	645	704	763	825	884	942	1001	1060	1122	1181	1239	1298	1357	1419	1478	1536	1595	1653
3000	494	556	618	679	741	803	868	930	992	1053	1115	1181	1242	1305	1366	1428	1493	1555	1617	1679	1741
3200	510	575	638	702	766	830	898	961	1025	1089	1153	1221	1285	1348	1412	1476	1543	1608			
3500	535	602	669	736	803	870	941	1008	1075	1142	1209	1280	1346	1413	1481	1547	1618				
3700	552	621	690	759	828	897	970	1039	1108	1177	1246	1319	1388	1457	1526	1596					
4000	576	648	720	793	865	937	1013	1085	1157	1230	1302	1378	1450	1522							
4200	593	667	741	816	890	964	1042	1116	1191	1265	1340	1418	1492								
4500	617	694	772	849	927	1004	1085	1163	1240	1318	1396	1477									
4700	634	713	793	873	952	1031	1115	1194	1274	1353	1433										
5000	658	741	823	906	989	1071	1158	1240	1323	1406	1489										

Premium system. SCREEN in 45° or 90° 85/95 mm cassette, side guidance - bottom beam in side guides

up to	1000	1200	1400	1600	1800	2000	2200	2400	2600	2800	3000
1000	244	275	306	336	367	398	428	459	490	520	551
1200	261	294	327	359	392	425	458	490	523	556	589
1500	285	321	357	393	429	465	501	537	572	609	644
1700	302	340	378	416	454	492	530	568	606	644	682
2000	327	368	409	450	491	531	573	614	655	696	737
2200	343	386	429	473	516	559	602	645	689	732	775
2500	367	413	460	507	553	599	645	692	738	785	831
2700	384	432	481	529	578	626	675	723	772	820	868
3000	408	459	512	563	615	666	718	769	821	872	924

**Remarks and surcharges**

- net prices - TAX should be added.
- standard colours: white RAL 9016, crème RAL 9001, silver RAL 9006, brown RAL 8014, anthracite RAL 7016, black gray RAL 7021.
- for an additional fee, varnishing in any colour from the RAL palette possible (extended lead time).

- BOX varnishing in RAL colour 22,00 € / pc.
- guides varnishing in RAL colour 13,75 € / set
- bottom beam varnishing in RAL colour 8,25 € / pc.



**GUIDANCE SCHEME**

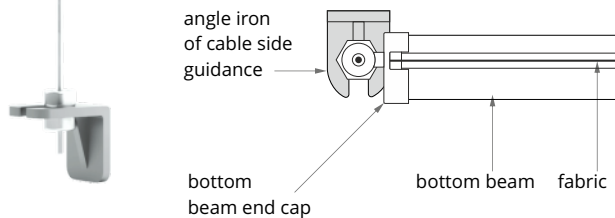

**CASSETTE**

- two types of cassettes to choose from: 45° and 90°, in three sizes: 85 mm, 95 mm and 125 mm.
- the maximum dimensions of shield for each of the cassette are given in a table on page 7<sup>th</sup>.

**FABRIC**

- high-quality fabrics made of plastics (glass fiber, PVC) from the best European producers guarantee resistance to weather conditions and a long useful life.

**CABLESIDE GUIDANCE**

- cable side guidance - the fabric is fixed to the bottom beam which moves on lines without using of guides.

**DRIVE**

- SCREEN Premium shields are offered only with an electric motor.
- the prices in the table do not include the price of the electric motor, it should be added. Price list of available drives on pages 32 - 33.

**COLOURS**

- standard colours are: white RAL 9016, crème RAL 9001, silver RAL 9006, brown RAL 8014, anthracite RAL 7016, black gray RAL 7021.
- on special order and at an additional charge, it is possible to varnish the product in any colour from the RAL palette (longer lead time).
- fabrics - according to the current pattern book.

**ANGLE IRON OF CABLE SIDE GUIDANCE**

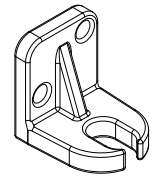

**STANDARD BOTTOM BEAM**

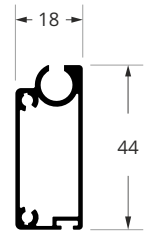

**CASSETTES 45°**

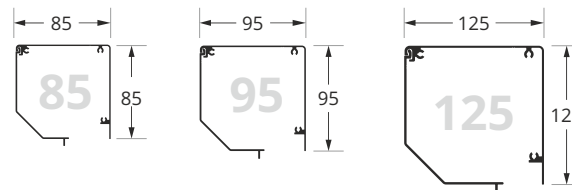

**CASSETTES 90°**

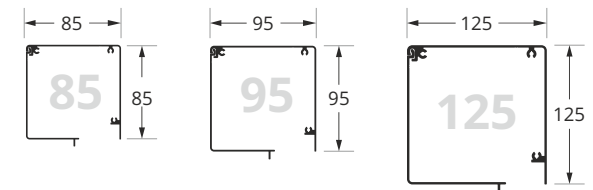

Premium system. SCREEN in 45° or 90° 125 mm cassette, side guidance - with cables - without guides

up to	1000	1200	1400	1600	1800	2000	2200	2400	2600	2800	3000	3200	3400	3600	3800	4000	4200	4400	4600	4800	5000
1000	304	340	376	412	447	483	522	558	593	629	665	704	739	775	811	847	886	922	958	993	1029
1200	316	352	389	426	463	500	540	577	613	650	687	727	764	801	838	874	915	951	988	1025	1062
1500	332	371	409	447	486	524	566	604	643	681	719	761	799	838	876	914	957	995	1033	1071	1110
1700	344	383	423	462	501	541	584	623	662	702	741	784	824	863	903	942	985	1024	1063	1103	1143
2000	361	402	443	483	524	565	610	651	692	733	774	818	859	900	941	982	1027	1068	1109	1149	1191
2200	372	414	456	498	540	582	627	670	712	754	796	842	884	926	968	1010	1055	1097	1139	1181	1223
2500	388	432	475	519	563	606	654	697	741	785	828	875	919	962	1006	1050	1097	1141	1184	1228	1271
2700	400	445	489	534	578	623	672	716	761	806	850	899	943	988	1032	1077	1125	1170	1215	1260	1304
3000	416	462	509	555	601	648	698	744	790	836	882	932	978	1025	1071	1117	1167	1214	1260	1306	1352
3200	428	475	523	570	617	665	715	763	810	857	905	956	1003	1050	1098	1145	1196	1243			
3500	445	494	542	591	640	689	742	790	839	888	937	990	1038	1087	1136	1185	1238				
3700	456	506	555	606	656	706	759	809	859	909	959	1013	1062	1113	1162	1212					
4000	472	524	575	627	678	730	785	837	888	940	991	1047	1098	1150							
4200	484	537	589	642	694	747	803	855	908	961	1013	1070	1122								
4500	500	554	609	663	717	772	829	883	937	992	1046	1104									
4700	512	567	622	678	733	788	847	902	958	1013	1068										
5000	528	585	642	699	756	812	873	930	987	1043	1100										

← width (mm)

Premium system. SCREEN in 45° or 90° 85/95 mm cassette, side guidance - with cables - without guides

up to	1000	1200	1400	1600	1800	2000	2200	2400	2600	2800	3000
1000	219	244	269	295	321	346	371	397	422	448	473
1200	230	256	283	310	336	363	389	416	442	469	495
1500	247	274	303	331	359	387	415	443	471	500	528
1700	258	287	316	346	374	404	433	462	492	521	550
2000	275	305	336	367	397	428	459	490	521	551	582
2200	286	318	350	381	413	445	477	509	541	573	604
2500	302	336	369	403	436	470	503	536	570	603	637
2700	314	348	383	417	452	486	521	556	590	624	659
3000	330	366	403	439	475	511	547	583	619	655	691

↑  
85 mm cassette  
↓

↑ height (mm)

Remarks and surcharges

- net prices - TAX should be added.
- standard colours: white RAL 9016, crème RAL 9001, silver RAL 9006, brown RAL 8014, anthracite RAL 7016, black gray RAL 7021.
- for an additional fee, varnishing in any colour from the RAL palette possible (extended lead time).

- BOX varnishing in RAL colour 22,00 € / pc.
- bottom beam varnishing in RAL colour 8,25 € / pc.

Premium system. SCREEN in 45° or 90° 125 mm cassette, side guidance - with cables - without guides

up to	1000	1200	1400	1600	1800	2000	2200	2400	2600	2800	3000	3200	3400	3600	3800	4000	4200	4400	4600	4800	5000	
1000	310	347	384	421	458	495	536	573	609	646	683	724	760	797	834	872	912	949	986	1023	1060	1098
1200	323	361	400	438	476	514	556	595	632	671	709	751	789	827	866	904	946	984	1022	1060	1098	1136
1500	342	382	422	462	502	542	586	626	666	706	747	791	830	871	911	951	995	1035	1075	1115	1156	1196
1700	354	396	437	479	520	561	607	648	689	731	772	818	859	900	942	983	1029	1070	1111	1153	1194	1235
2000	373	416	460	503	546	590	636	680	724	767	810	857	901	944	988	1031	1078	1122	1165	1208	1252	1295
2200	385	430	475	519	564	609	657	702	747	791	836	885	929	974	1019	1064	1112	1156	1201	1246	1291	1336
2500	404	450	497	544	590	637	687	734	781	827	874	924	971	1017	1064	1111	1161	1208	1255	1302	1348	1394
2700	417	464	512	560	608	656	708	756	803	852	900	951	999	1047	1095	1143	1195	1243	1291	1339	1386	1434
3000	435	484	535	584	634	684	738	788	837	887	937	991	1041	1091	1141	1191	1244	1294	1344	1394	1444	1494
3200	447	499	550	601	652	704	758	810	861	912	963	1018	1070	1120	1172	1223	1278	1329	1380	1431	1482	1533
3500	466	519	572	625	679	732	789	842	895	948	1001	1058	1111	1164	1218	1271	1328	1381	1434	1487	1540	1593
3700	479	533	587	642	696	751	809	863	918	972	1027	1085	1139	1194	1248	1303	1358	1413	1468	1523	1578	1633
4000	497	553	610	666	722	779	839	895	952	1008	1065	1125	1181	1238	1295	1352	1409	1466	1523	1580	1637	1694
4200	510	567	625	683	740	798	860	917	975	1033	1090	1152	1210	1268	1326	1384	1442	1500	1558	1616	1674	1732
4500	528	587	647	707	767	827	890	949	1009	1069	1129	1192	1254	1316	1378	1440	1502	1564	1626	1688	1750	1812
4700	541	602	662	724	784	846	910	971	1032	1093	1154	1217	1279	1341	1403	1465	1527	1589	1651	1713	1775	1837
5000	559	622	685	748	811	873	940	1003	1066	1129	1192	1257	1320	1383	1446	1509	1572	1635	1698	1761	1824	1887

Premium system. SCREEN in 45° or 90° 85/95 mm cassette, side guidance - with cables - without guides

up to	1000	1200	1400	1600	1800	2000	2200	2400	2600	2800	3000
1000	225	251	278	304	332	358	385	412	438	465	492
1200	237	265	294	321	349	378	405	433	462	489	517
1500	256	285	316	346	375	406	436	465	495	525	555
1700	269	300	331	362	393	425	456	487	519	550	581
2000	287	320	353	386	419	452	486	519	553	586	619
2200	300	334	368	403	438	472	506	541	576	610	645
2500	318	354	391	427	464	500	537	573	609	646	683
2700	330	368	406	444	482	519	557	595	633	670	708
3000	349	388	428	468	508	547	587	627	667	706	746

Remarks and surcharges

- net prices - TAX should be added.
- standard colours: white RAL 9016, crème RAL 9001, silver RAL 9006, brown RAL 8014, anthracite RAL 7016, black gray RAL 7021.
- for an additional fee, varnishing in any colour from the RAL palette possible (extended lead time).

BOX varnishing in RAL colour	22,00 € / pc.
bottom beam varnishing in RAL colour	8,25 € / pc.

Premium system. SCREEN in 45° or 90° 125 mm cassette, side guidance - with cables - without guides

up to	1000	1200	1400	1600	1800	2000	2200	2400	2600	2800	3000	3200	3400	3600	3800	4000	4200	4400	4600	4800	5000
1000	330	371	412	453	493	534	579	620	661	701	742	787	827	869	909	951	995	1036	1077	1117	1159
1200	347	390	433	476	519	562	608	652	694	737	780	827	870	913	956	998	1045	1088	1131	1174	1217
1500	371	417	464	509	555	601	651	698	743	789	836	886	931	978	1024	1070	1120	1166	1212	1258	1304
1700	388	436	484	532	581	629	681	729	777	825	873	925	973	1021	1070	1118	1170	1218	1266	1314	1363
2000	412	464	515	566	617	669	723	775	827	878	929	984	1035	1086	1138	1189	1244	1296	1347	1398	1449
2200	429	482	535	589	643	696	753	806	860	913	966	1024	1077	1131	1184	1238	1294	1348	1401	1454	1508
2500	453	510	566	623	679	736	796	853	909	966	1022	1082	1139	1195	1252	1308	1369	1425	1482	1539	1595
2700	470	528	587	645	704	763	825	884	942	1001	1060	1122	1181	1239	1298	1357	1419	1478	1536	1595	1653
3000	494	556	618	679	741	803	868	930	992	1053	1115	1181	1242	1305	1366	1428	1493	1555	1617	1679	1741
3200	510	575	638	702	766	830	898	961	1025	1089	1153	1221	1285	1348	1412	1476	1543	1608			
3500	535	602	669	736	803	870	941	1008	1075	1142	1209	1280	1346	1413	1481	1547	1618				
3700	552	621	690	759	828	897	970	1039	1108	1177	1246	1319	1388	1457	1526	1596					
4000	576	648	720	793	865	937	1013	1085	1157	1230	1302	1378	1450	1522							
4200	593	667	741	816	890	964	1042	1116	1191	1265	1340	1418	1492								
4500	617	694	772	849	927	1004	1085	1163	1240	1318	1396	1477									
4700	634	713	793	873	952	1031	1115	1194	1274	1353	1433										
5000	658	741	823	906	989	1071	1158	1240	1323	1406	1489										

← width (mm)

Premium system. SCREEN in 45° or 90° 85/95 mm cassette, side guidance - with cables - without guides

up to	1000	1200	1400	1600	1800	2000	2200	2400	2600	2800	3000
1000	244	275	306	336	367	398	428	459	490	520	551
1200	261	294	327	359	392	425	458	490	523	556	589
1500	285	321	357	393	429	465	501	537	572	609	644
1700	302	340	378	416	454	492	530	568	606	644	682
2000	327	368	409	450	491	531	573	614	655	696	737
2200	343	386	429	473	516	559	602	645	689	732	775
2500	367	413	460	507	553	599	645	692	738	785	831
2700	384	432	481	529	578	626	675	723	772	820	868
3000	408	459	512	563	615	666	718	769	821	872	924

↑  
85 mm cassette  
↓

↑ height (mm)

**Remarks and surcharges**

- net prices - TAX should be added.
- standard colours: white RAL 9016, crème RAL 9001, silver RAL 9006, brown RAL 8014, anthracite RAL 7016, black gray RAL 7021.
- for an additional fee, varnishing in any colour from the RAL palette possible (extended lead time).

• BOX varnishing in RAL colour	22,00 € / pc.
• bottom beam varnishing in RAL colour	8,25 € / pc.



**GUIDANCE SCHEME**

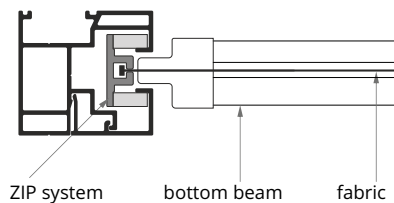

**CASSETTE**

- the flush-mounted SCREEN is available with a 90 ° cassette in the size of 105 or 125 mm.
- the maximum dimensions of shield for each of the cassette are given in a table on page 7<sup>th</sup>.

**FABRIC**

- high-quality fabrics made of plastics (glass fiber, PVC) from the best European producers guarantee resistance to weather conditions and a long usefull life.

**ZIP SCREEN GUIDANCE**

- "ZIP SCREEN" guidance is an innovative way of guidance where the lower beam and material move inside the guides. This enables the perfect tension of the material, increases the resistance of the shield to difficult weather conditions, and additionally, when the shield is fully lowered, it fulfills a protective function, e.g. against dirt or insects.

**DRIVE**

- SCREEN Premium shields are offered only with an electric motor.
- the prices in the table do not include the price of the electric motor, it should be added. Price list of available drives on pages 32 - 33.

**COLOURS**

- standard colours are: white RAL 9016, crème RAL 9001, silver RAL 9006, brown RAL 8014, anthracite RAL 7016, black gray RAL 7021.
- on special order and at an additional charge, it is possible to varnish the product in any colour from the RAL palette (longer lead time).
- fabrics - according to the current pattern book..

**SIDE GUIDES (for partly building-over)**

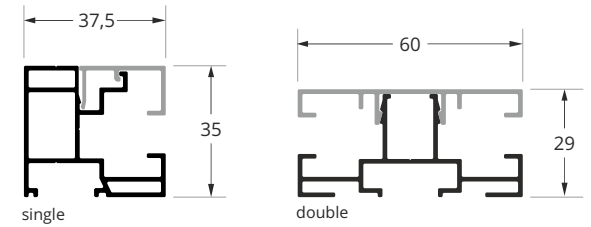

**SIDE GUIDES (for complete building-over)**

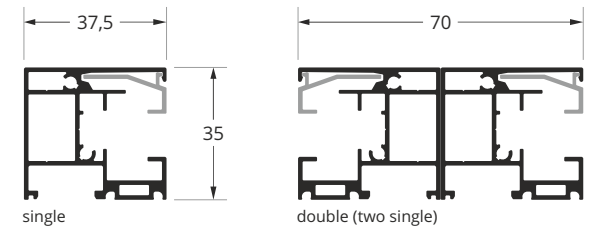

**SPACER PROFILE**

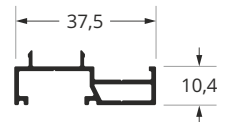

**CASSETTES**

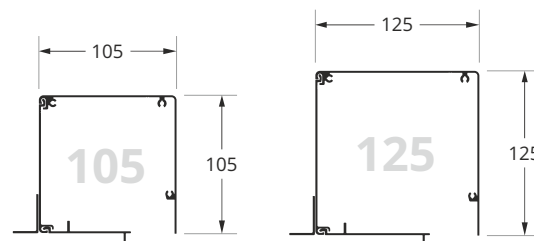

**STANDARD BOTTOM BEAM**

From 1 m up to 5 m.

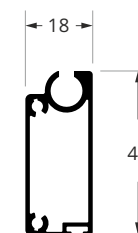

**REINFORCED BOTTOM BEAM**

From 0 up to 1 m  
From 5 m up to 6 m.

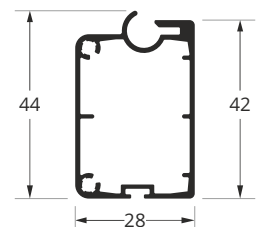



Premium system. SCREEN in SKP 125 mm box, ZIP SCREEN guidance system

up to	105 mm cassette ←															→ 125 mm cassette						width [mm]				
	1000	1200	1400	1600	1800	2000	2200	2400	2600	2800	3000	3200	3400	3600	3800	4000	4200	4400	4600	4800	5000		5200	5400	5600	5800
1000	384	425	466	507	549	590	636	677	718	759	800	846	887	928	969	1011	1056	1097	1139	1179	1221	1262	1303	1344	1385	1426
1200	405	447	489	532	574	617	664	706	749	791	833	880	923	965	1007	1050	1097	1139	1182	1224	1267	1309	1352	1395	1438	1480
1500	435	479	524	568	612	657	705	750	794	838	883	932	976	1020	1064	1108	1157	1202	1246	1290	1335	1379	1423	1468	1512	1557
1700	456	501	547	593	638	684	734	779	825	870	915	966	1011	1057	1103	1148	1198	1244	1289	1335	1380	1426	1471	1517	1562	1608
2000	486	533	581	629	676	723	775	823	870	917	965	1016	1064	1112	1159	1207	1258	1306	1353	1401	1448	1496	1543	1591	1638	1686
2200	507	555	604	653	701	751	803	852	901	950	998	1051	1100	1148	1197	1246	1299	1348	1397	1445	1494	1542	1591	1639	1688	1736
2500	537	587	638	689	740	790	845	895	946	997	1047	1102	1153	1203	1254	1305	1360	1410	1461	1511	1562	1612	1663	1713	1764	1814
2700	558	610	662	713	765	817	873	925	977	1029	1081	1137	1189	1240	1293	1344	1400	1452	1504	1556	1608	1660	1711	1763	1815	1867
3000	588	642	696	749	803	857	915	969	1023	1076	1130	1188	1242	1295	1349	1403	1461	1514	1568	1622	1676	1729	1783	1837	1891	1945
3200	609	664	719	774	829	884	943	998	1053	1108	1163	1223	1277	1332	1387	1442	1502	1557								
3500	640	697	754	810	868	925	986	1043	1100	1157	1214	1275	1332	1389	1446	1503	1565									
3700	660	718	776	835	892	951	1013	1071	1129	1187	1245	1308	1366	1424	1482	1540										
4000	690	750	811	870	930	991	1055	1115	1175	1234	1295	1359	1419	1479												
4200	711	772	834	895	956	1018	1083	1144	1205	1267	1328	1393	1455													
4500	742	804	868	931	994	1057	1125	1188	1251	1314	1377	1444														
4700	762	827	891	955	1020	1084	1153	1217	1281	1346	1410															
5000	792	859	925	991	1058	1123	1195	1261	1327	1393	1460															

Remarks and surcharges

- net prices - TAX should be added.
- standard colours: white RAL 9016, crème RAL 9001, silver RAL 9006, brown RAL 8014, anthracite RAL 7016, black gray RAL 7021.
- for an additional fee, varnishing in any colour from the RAL palette possible (extended lead time).

- revision flap varnishing in RAL colour 18,00 € / pc.
- side guides varnishing in RAL colour 13,75 € / set
- varnishing the side guides spacer profile in RAL colour 8,25 € / set
- bottom beam varnishing in RAL colour 8,25 € / set
- surcharge for XPS 10 mm insulation 12,50 € / pc.
- surcharge for Onduterm XL 3 mm insulation 4,25 € / rm
- surcharge for side guide spacer profile 16,50 € / rm

Premium system. SCREEN in SKP 125 mm box, ZIP SCREEN guidance system

up to	105 mm cassette ←																→ 125 mm cassette										width (mm)
	1000	1200	1400	1600	1800	2000	2200	2400	2600	2800	3000	3200	3400	3600	3800	4000	4200	4400	4600	4800	5000	5200	5400	5600	5800	6000	
1000	390	432	475	517	560	602	649	691	733	776	818	865	907	950	992	1035	1081	1124	1167	1209	1251	1294	1336	1378	1421	1463	
1200	412	456	500	544	587	632	680	724	768	811	855	904	948	991	1035	1080	1128	1172	1215	1259	1303	1348	1392	1436	1480	1524	
1500	444	490	536	582	629	675	725	772	818	864	910	961	1007	1053	1099	1145	1196	1242	1288	1334	1380	1427	1473	1519	1565	1612	
1700	466	514	561	609	657	704	757	804	852	899	947	999	1046	1094	1142	1190	1242	1289	1337	1385	1432	1480	1528	1575	1623	1670	
2000	498	548	598	648	698	748	802	852	902	952	1002	1056	1106	1156	1206	1256	1310	1360	1409	1459	1509	1559	1609	1659	1709	1759	
2200	520	571	623	674	726	777	833	884	936	987	1039	1094	1146	1197	1248	1300	1356	1407	1459	1510	1561	1612	1663	1715	1766	1817	
2500	552	606	660	713	767	821	879	932	986	1039	1093	1151	1205	1258	1312	1366	1424	1477	1531	1585	1638	1692	1745	1799	1853	1906	
2700	574	630	685	740	795	850	910	965	1020	1075	1130	1190	1245	1300	1355	1410	1470	1525	1580	1635	1690	1745	1801	1856	1911	1966	
3000	607	664	721	779	836	893	956	1013	1070	1128	1185	1247	1304	1361	1419	1476	1538	1595	1652	1710	1767	1825	1882	1940	1997	2055	
3200	629	687	746	805	864	923	986	1045	1104	1163	1222	1285	1344	1402	1461	1520	1584	1643									
3500	661	722	783	844	905	967	1032	1093	1154	1215	1277	1342	1403	1464	1525	1586	1652										
3700	683	745	808	871	933	996	1063	1125	1188	1251	1313	1380	1443	1505	1568	1631											
4000	715	779	845	909	974	1039	1109	1173	1238	1303	1368	1437	1502	1567													
4200	737	803	870	936	1002	1069	1139	1206	1272	1338	1405	1476	1542														
4500	769	837	906	975	1043	1112	1185	1254	1322	1391	1459	1532															
4700	791	861	931	1001	1072	1142	1216	1286	1356	1426	1497																
5000	823	895	968	1040	1113	1185	1262	1334	1406	1479	1551																

**Remarks and surcharges**

- net prices - TAX should be added.
- standard colours: white RAL 9016, crème RAL 9001, silver RAL 9006, brown RAL 8014, anthracite RAL 7016, black gray RAL 7021.
- for an additional fee, varnishing in any colour from the RAL palette possible (extended lead time).

revision flap varnishing in RAL colour	18,00 € / pc.
side guides varnishing in RAL colour	13,75 € / set
varnishing the side guides spacer profile in RAL colour	8,25 € / set
bottom beam varnishing in RAL colour	8,25 € / set
surcharge for XPS 10 mm insulation	12,50 € / pc.
surcharge for Onduterm XL 3 mm insulation	4,25 € / rm
surcharge for side guide spacer profile	16,50 € / rm

Premium system. SCREEN in SKP 125 mm box, ZIP SCREEN guidance system

up to	105 mm cassette ←														→ 125 mm cassette										width (mm)	
	1000	1200	1400	1600	1800	2000	2200	2400	2600	2800	3000	3200	3400	3600	3800	4000	4200	4400	4600	4800	5000	5200	5400	5600		5800
1000	405	456	502	548	595	641	692	739	785	831	878	929	975	1021	1068	1114	1164	1211	1258	1304	1350	1396	1443	1489	1535	1582
1200	436	485	533	582	630	679	732	781	830	878	927	979	1028	1077	1125	1174	1227	1276	1324	1373	1422	1471	1520	1569	1618	1667
1500	474	526	578	630	682	734	791	843	895	947	999	1056	1108	1160	1212	1264	1320	1373	1424	1476	1529	1581	1633	1685	1737	1790
1700	500	554	608	663	717	772	831	884	939	993	1048	1107	1161	1215	1270	1324	1383	1437	1491	1546	1600	1655	1709	1763	1818	1872
2000	538	595	653	711	769	827	889	947	1004	1062	1120	1182	1240	1298	1356	1414	1476	1534	1591	1649	1707	1765	1823	1881	1938	1996
2200	564	624	684	744	804	864	929	989	1049	1109	1169	1234	1293	1353	1414	1474	1538	1598	1659	1719	1779	1838	1898	1958	2018	2078
2500	602	665	729	793	856	920	987	1051	1114	1178	1241	1309	1373	1436	1500	1564	1631	1695	1758	1822	1885	1949	2012	2076	2139	2203
2700	628	694	760	825	891	957	1027	1093	1159	1224	1290	1360	1426	1492	1558	1624	1694	1760	1825	1891	1957	2023	2089	2155	2220	2286
3000	666	735	804	874	943	1012	1086	1155	1224	1294	1363	1437	1506	1575	1644	1713	1787	1856	1925	1994	2064	2133	2202	2272	2341	2410
3200	692	763	835	906	978	1050	1125	1197	1268	1340	1412	1488	1559	1630	1702	1774	1849	1921								
3500	728	802	877	951	1026	1101	1180	1254	1329	1403	1478	1557	1632	1706	1780	1855	1934									
3700	756	833	910	988	1065	1142	1224	1301	1378	1455	1532	1614	1692	1769	1846	1923										
4000	794	874	955	1036	1117	1198	1283	1363	1444	1524	1605	1690	1771	1851												
4200	820	903	986	1069	1152	1235	1322	1405	1488	1571	1654	1741	1824													
4500	858	944	1031	1117	1204	1290	1381	1467	1554	1640	1726	1817														
4700	884	973	1061	1150	1239	1328	1420	1509	1598	1686	1775															
5000	922	1014	1106	1198	1290	1382	1479	1571	1663	1755	1848															

**Remarks and surcharges**

- net prices - TAX should be added.
- standard colours: white RAL 9016, crème RAL 9001, silver RAL 9006, brown RAL 8014, anthracite RAL 7016, black gray RAL 7021.
- for an additional fee, varnishing in any colour from the RAL palette possible (extended lead time).

revision flap varnishing in RAL colour	18,00 € / pc.
side guides varnishing in RAL colour	13,75 € / set
varnishing the side guides spacer profile in RAL colour	8,25 € / set
bottom beam varnishing in RAL colour	8,25 € / set
surcharge for XPS 10 mm insulation	12,50 € / pc.
surcharge for Onduterm XL 3 mm insulation	4,25 € / rm
surcharge for side guide spacer profile	16,50 € / rm



**GUIDANCE SCHEME**

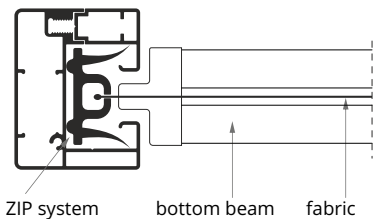

**CASSETTE**

- 90° cassette made of extruded aluminium, occurs in three sizes.
- the maximum dimensions of shield for each of the cassette are given in a table on page 8<sup>th</sup>.

**FABRIC**

- high-quality fabrics made of plastics (glass fiber, PVC) from the best European producers guarantee resistance to weather conditions and a long useful life.

**ZIP SCREEN GUIDANCE**

- "ZIP SCREEN" guidance is an innovative way of guidance where the lower beam and material move inside the guides. This enables the perfect tension of the material, increases the resistance of the shield to difficult weather conditions, and additionally, when the shield is fully lowered, it fulfills a protective function, e.g. against dirt or insects.

**DRIVE**

- SCREEN Standard shields are offered only with an electric motor.
- the prices in the table do not include the price of the electric motor, it should be added. Price list of available drives on pages 32 - 33.

**COLOURS**

- standard colours are: 01 silver RAL 9006, 08B dark brown 8019 \*, 09B brown 8014 \*, 15 cream white 9001 \*, 20B black 9005 \*, 22B ultra white 9016 \*, 23B gray anthracite 7016 \*, 34B quartz gray 7039 \*, 37B gray aluminum (\* - similar to colours with this number from the RAL palette).
- for a special request and for an additional fee, varnishing in any colour from the RAL palette possible (extended lead time).
- fabrics - according to the current pattern book.

**SIDE GUIDES**

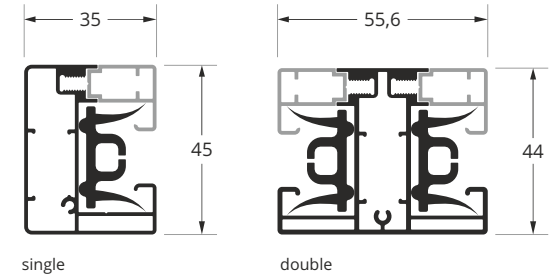

**BOTTOM BEAM**

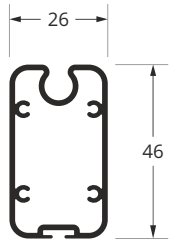

**CASSETTES**

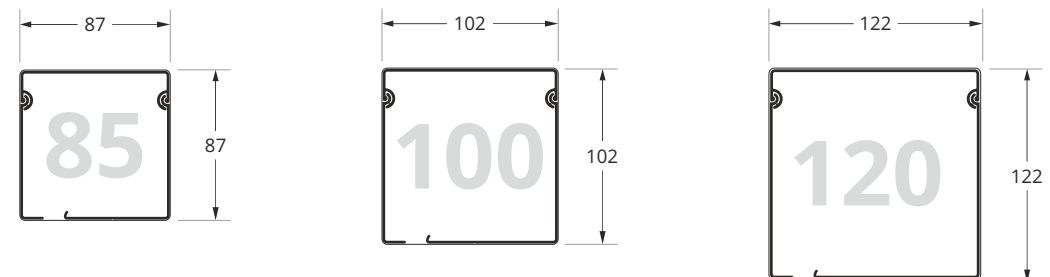

SCREEN Standard 90°, 100 or 120 mm, ZIP SCREEN guidance system

up to	1000	1200	1400	1600	1800	2000	2200	2400	2600	2800	3000	3200	3400	3600	3800	4000
1000	316	350	383	417	451	485	523	556	590	624	658	695	729	763	796	830
1200	333	368	402	437	472	507	545	580	615	650	684	723	758	793	827	862
1500	358	394	430	466	503	539	579	615	651	688	724	764	800	837	873	909
1700	375	412	449	487	523	561	602	639	676	714	751	792	829	866	904	941
2000	399	438	477	516	554	593	636	674	713	752	791	833	872	911	949	988
2200	416	456	496	535	575	615	659	698	738	778	818	861	901	940	980	1020
2500	441	482	523	565	606	647	692	733	775	816	857	902	943	984	1026	1067
2700	458	500	543	585	627	669	715	757	800	842	884	930	972	1014	1057	1099
3000	483	526	570	614	658	701	749	793	836	880	924	971	1015	1058	1102	1146
3200	500	544	589	634	679	723	772	816	861	906	950	999	1044	1088	1133	1178
3500	525	571	618	664	711	757	807	853	899	946	992	1042	1088	1134	1181	1227
3700	541	589	636	683	730	778	828	875	923	970	1017	1068	1115	1162	1209	1256
4000	566	615	663	712	761	810	862	911	959	1008	1056	1109	1158	1206		
4200	583	633	683	732	782	832	885	934	984	1033	1083	1137	1187			
4500	608	659	710	761	812	864	918	970	1021	1072	1123	1177				
4700	625	677	729	781	833	886	941	993	1045	1098	1150					
5000	649	703	757	810	864	918	975	1029	1082	1136	1190					

SCREEN Standard 90° 85 mm, ZIP SCREEN guidance system

up to	1000	1200	1400	1600	1800	2000	2200	2400	2600	2800	3000
1000	246	271	295	319	343	367	391	415	439	464	488
1200	263	288	313	338	364	389	414	439	464	489	514
1500	288	314	341	368	394	421	448	474	501	527	554
1700	305	333	360	387	415	443	471	498	526	553	581

**Remarks and surcharges**

- net prices - TAX should be added.
- standard colours are: 01 silver RAL 9006, 08B dark brown 8019 \*, 09B brown 8014 \*, 15 cream white 9001 \*, 20B black 9005 \*, 22 ultra white 9016 \*, 23B gray anthracite 7016 \*, 34B quartz gray 7039 \*, 37B gray aluminum (\* - similar to colours with this number from the RAL palette).
- for an additional fee, varnishing in any colour from the RAL palette possible (extended lead time).

- BOX varnishing in RAL colour 22,00 € / pc.
- guides varnishing in RAL colour 13,75 € / set
- bottom beam varnishing in RAL colour 8,25 € / pc.

**SCREEN Standard 90°, 100 or 120 mm, ZIP SCREEN guidance system**

up to	1000	1200	1400	1600	1800	2000	2200	2400	2600	2800	3000	3200	3400	3600	3800	4000
1000	322	357	392	427	462	497	536	571	606	641	676	715	750	785	820	855
1200	340	377	413	449	485	521	561	598	634	670	706	746	782	819	855	891
1500	367	405	443	481	519	557	599	637	675	714	752	793	832	870	908	946
1700	385	424	464	503	542	582	625	664	703	743	782	825	865	904	944	983
2000	411	453	494	535	576	618	663	704	745	786	827	872	913	955	996	1037
2200	430	472	515	557	599	642	688	730	773	816	858	904	946	988	1031	1074
2500	456	500	545	589	634	678	726	770	814	859	903	951	995	1039	1084	1128
2700	474	520	566	611	657	702	751	797	843	888	934	983	1028	1074	1119	1165
3000	501	548	596	643	691	738	789	837	884	931	979	1030	1077	1124	1172	1219
3200	519	568	617	665	714	762	815	863	912	960	1009	1062	1110	1159	1207	1256
3500	546	596	647	697	748	798	852	903	953	1004	1054	1109	1159	1209	1260	1310
3700	564	616	667	719	771	823	878	929	981	1033	1085	1140	1192	1244	1295	1347
4000	591	644	698	751	805	859	916	969	1023	1076	1130	1187	1241	1294		
4200	609	664	719	773	828	883	941	996	1050	1105	1160	1219	1274			
4500	635	692	749	805	862	919	979	1036	1092	1149	1206	1265				
4700	654	711	769	827	885	943	1004	1062	1120	1178	1236					
5000	680	740	800	859	919	979	1042	1102	1162	1221	1281					

**SCREEN Standard 90° 85 mm, ZIP SCREEN guidance system**

up to	1000	1200	1400	1600	1800	2000	2200	2400	2600	2800	3000
1000	252	278	303	329	354	379	404	430	455	481	506
1200	270	297	324	350	377	403	430	457	483	510	536
1500	297	325	354	382	411	439	468	496	525	553	581
1700	315	345	374	404	434	464	494	523	553	582	612

**Remarks and surcharges**

- net prices - TAX should be added.
- standard colours are: 01 silver RAL 9006, 08B dark brown 8019 \*, 09B brown 8014 \*, 15 cream white 9001 \*, 20B black 9005 \*, 22 ultra white 9016 \*, 23B gray anthracite 7016 \*, 34B quartz gray 7039 \*, 37B gray aluminum (\* - similar to colours with this number from the RAL palette).
- for an additional fee, varnishing in any colour from the RAL palette possible (extended lead time).

BOX varnishing in RAL colour	22,00 € / pc.
guides varnishing in RAL colour	13,75 € / set
bottom beam varnishing in RAL colour	8,25 € / pc.

**SCREEN Standard 90°, 100 or 120 mm, ZIP SCREEN guidance system**

up to	1000	1200	1400	1600	1800	2000	2200	2400	2600	2800	3000	3200	3400	3600	3800	4000
1000	342	381	420	459	498	537	579	618	657	696	735	778	817	856	895	934
1200	364	405	446	487	528	569	614	655	696	737	778	822	863	904	945	986
1500	396	440	485	529	573	617	664	708	752	797	841	888	932	976	1021	1064
1700	419	465	511	557	603	649	699	745	791	837	883	933	979	1025	1071	1117
2000	451	500	549	599	647	697	750	799	848	897	946	999	1048	1097	1146	1195
2200	473	524	575	626	678	729	784	835	886	937	988	1043	1094	1145	1197	1248
2500	506	560	614	668	723	777	834	889	943	997	1051	1109	1163	1217	1272	1326
2700	528	584	640	696	753	809	869	925	981	1038	1094	1153	1210	1266	1322	1378
3000	560	620	679	738	797	857	919	979	1038	1098	1157	1220	1279	1338	1397	1456
3200	582	644	705	766	828	889	954	1015	1076	1138	1199	1264	1325	1386	1448	1509
3500	613	677	741	805	869	933	1000	1064	1128	1192	1256	1324	1387	1451	1515	1579
3700	637	704	770	836	903	969	1039	1105	1172	1238	1304	1374	1441	1507	1573	1640
4000	670	739	808	878	947	1017	1090	1159	1228	1298	1367	1440	1510	1579		
4200	692	763	835	906	978	1049	1124	1195	1266	1338	1410	1484	1556			
4500	724	799	873	948	1022	1097	1174	1249	1324	1398	1473	1550				
4700	746	823	900	976	1052	1129	1209	1285	1362	1438	1515					
5000	779	858	938	1017	1097	1176	1260	1339	1419	1498	1578					

**SCREEN Standard 90° 85 mm, ZIP SCREEN guidance system**

up to	1000	1200	1400	1600	1800	2000	2200	2400	2600	2800	3000
1000	272	302	331	360	389	418	448	477	507	536	565
1200	294	325	357	388	420	451	482	514	545	576	608
1500	327	361	395	430	464	498	533	567	602	636	670
1700	349	385	422	458	494	531	567	604	640	676	713

**Remarks and surcharges**

- net prices - TAX should be added.
- standard colours are: 01 silver RAL 9006, 08B dark brown 8019 \*, 09B brown 8014 \*, 15 cream white 9001 \*, 20B black 9005 \*, 22 ultra white 9016 \*, 23B gray anthracite 7016 \*, 34B quartz gray 7039 \*, 37B gray aluminum (\* - similar to colours with this number from the RAL palette).
- for an additional fee, varnishing in any colour from the RAL palette possible (extended lead time).

- BOX varnishing in RAL colour 22,00 € / pc.
- guides varnishing in RAL colour 13,75 € / set
- bottom beam varnishing in RAL colour 8,25 € / pc.



**GUIDANCE SCHEME**

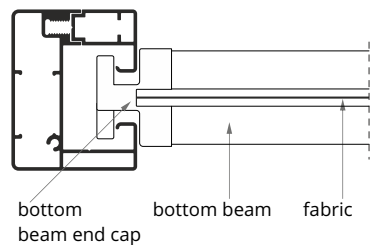

**CASSETTE**

- 90° cassette made of extruded aluminium, occurs in three sizes.  
 - the maximum dimensions of shield for each of the cassette are given in a table on page 8<sup>th</sup>.

**FABRIC**

- high-quality fabrics made of plastics (glass fiber, PVC) from the best European producers guarantee resistance to weather conditions and a long useful life.

**GUIDANCE - BOTTOM BEAM IN SIDE GUIDES**

- bottom beam in side guides - the fabric is not recessed in the guides, only the bottom beam is guided inside them.

**DRIVE**

- SCREEN Standard shields are offered only with an electric motor.  
 - the prices in the table do not include the price of the electric motor, it should be added. Price list of available drives on pages 32 - 33.

**COLOURS**

- standard colours are: 01 silver RAL 9006, 08B dark brown 8019 \*, 09B brown 8014 \*, 15 cream white 9001 \*, 20B black 9005 \*, 22B ultra white 9016 \*, 23B gray anthracite 7016 \*, 34B quartz gray 7039 \*, 37B gray aluminum (\* - similar to colours with this number from the RAL palette).  
 - for a special request and for an additional fee, varnishing in any colour from the RAL palette possible (extended lead time).  
 - fabrics - according to the current pattern book.

**SIDE GUIDES**

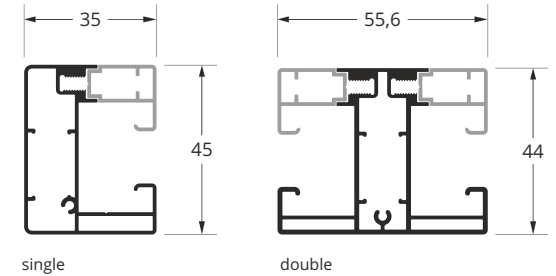

**BOTTOM BEAM**

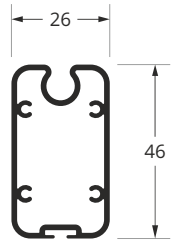

**CASSETTES**

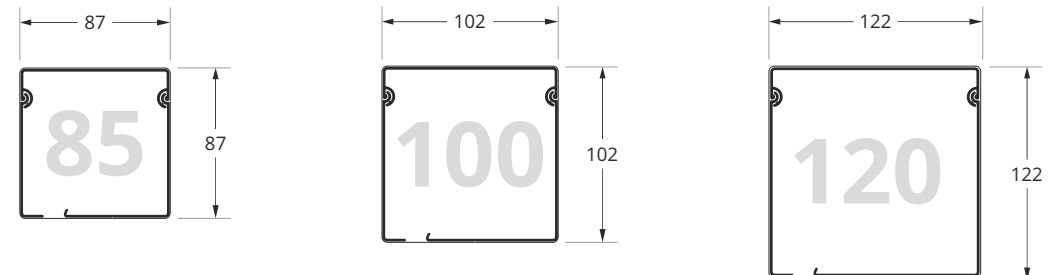



SCREEN Standard 90°, 100 or 120 mm, side guidance - bottom beam in side guides

up to	1000	1200	1400	1600	1800	2000	2200	2400	2600	2800	3000	3200	3400	3600	3800	4000
1000	289	323	357	391	424	458	495	529	563	597	631	668	701	736	769	804
1200	300	334	369	404	439	474	512	547	582	616	651	690	725	760	794	829
1500	315	352	388	424	460	497	537	573	609	645	682	722	758	794	831	867
1700	326	363	401	438	475	512	553	591	628	665	703	744	781	818	855	893
2000	342	381	420	458	497	536	578	617	656	694	733	775	814	853	892	931
2200	353	392	432	472	512	552	595	635	674	714	754	797	837	877	917	957
2500	368	409	451	492	533	575	619	661	702	743	784	829	870	912	953	994
2700	379	421	463	506	548	590	636	679	720	763	805	851	893	936	978	1020
3000	395	438	482	526	570	613	661	704	748	792	835	883	926	970	1014	1058
3200	405	450	495	540	585	630	677	722	767	812	856	905	950	994	1039	1083
3400	422	468	515	561	607	654	703	750	796	842	889	939	985	1031	1078	1124

← width (mm)

SCREEN Standard 90° 85 mm, side guidance - bottom beam in side guides

up to	1000	1200	1400	1600	1800	2000	2200	2400	2600	2800	3000
1000	207	231	255	279	304	328	352	376	400	425	449
1200	218	243	269	294	319	344	369	394	419	444	470
1500	234	260	287	314	340	367	394	420	447	474	500
1700	245	272	300	327	355	383	410	438	466	493	521

↑ height (mm)

**Remarks and surcharges**

- net prices - TAX should be added.
- standard colours are: 01 silver RAL 9006, 08B dark brown 8019 \*, 09B brown 8014 \*, 15 cream white 9001 \*, 20B black 9005 \*, 22B ultra white 9016 \*, 23B gray anthracite 7016 \*, 34B quartz gray 7039 \*, 37B gray aluminum (\* - similar to colours with this number from the RAL palette).
- for an additional fee, varnishing in any colour from the RAL palette possible (extended lead time).

- BOX varnishing in RAL colour 22,00 € / pc.
- guides varnishing in RAL colour 13,75 € / set
- bottom beam varnishing in RAL colour 8,25 € / pc.

SCREEN Standard 90°, 100 or 120 mm, side guidance - bottom beam in side guides

up to	1000	1200	1400	1600	1800	2000	2200	2400	2600	2800	3000	3200	3400	3600	3800	4000
1000	295	330	365	400	435	470	509	544	579	614	649	688	722	758	793	828
1200	307	343	380	416	452	489	528	565	601	637	673	713	750	786	822	858
1500	325	363	401	439	477	515	557	595	633	671	709	751	789	827	865	904
1700	336	376	415	455	494	533	576	616	655	695	734	777	816	855	895	934
2000	354	395	437	478	519	560	605	646	688	729	770	814	856	897	938	980
2200	366	409	451	494	536	578	624	667	709	752	794	840	883	925	968	1010
2500	383	428	472	516	561	605	653	697	742	786	830	878	922	967	1011	1055
2700	396	441	487	532	578	623	673	718	763	809	855	904	949	995	1040	1086
3000	413	460	508	555	603	650	701	748	796	843	890	941	989	1036	1084	1131
3200	425	474	522	571	620	669	720	769	818	866	915	967	1016	1064	1113	1162
3400	443	493	544	594	645	695	749	800	850	901	951	1005	1055	1106	1157	1207

← width (mm)

SCREEN Standard 90° 85 mm, side guidance - bottom beam in side guides

up to	1000	1200	1400	1600	1800	2000	2200	2400	2600	2800	3000
1000	213	239	264	289	315	340	366	391	416	442	467
1200	226	252	279	305	332	359	385	412	438	465	492
1500	243	271	300	329	357	385	414	442	471	499	527
1700	255	285	314	344	373	403	433	463	493	522	552

↑ height (mm)

**Remarks and surcharges**

- net prices - TAX should be added.
- standard colours are: 01 silver RAL 9006, 08B dark brown 8019 \*, 09B brown 8014 \*, 15 cream white 9001 \*, 20B black 9005 \*, 22B ultra white 9016 \*, 23B gray anthracite 7016 \*, 34B quartz gray 7039 \*, 37B gray aluminum (\* - similar to colours with this number from the RAL palette).
- for an additional fee, varnishing in any colour from the RAL palette possible (extended lead time).

BOX varnishing in RAL colour	22,00 € / pc.
guides varnishing in RAL colour	13,75 € / set
bottom beam varnishing in RAL colour	8,25 € / pc.

SCREEN Standard 90°, 100 or 120 mm, side guidance - bottom beam in side guides

up to	1000	1200	1400	1600	1800	2000	2200	2400	2600	2800	3000	3200	3400	3600	3800	4000
1000	315	354	393	432	471	510	552	591	630	669	708	751	789	829	868	907
1200	331	372	413	454	495	536	581	622	662	703	745	789	830	871	912	953
1500	354	398	442	486	530	574	622	666	710	754	798	846	890	934	978	1022
1700	370	416	462	509	555	601	650	696	742	789	835	884	930	976	1023	1069
2000	394	443	492	541	590	639	692	741	790	839	889	941	990	1039	1089	1138
2200	410	461	512	563	614	665	720	771	822	873	925	979	1031	1082	1133	1184
2500	433	487	541	596	650	704	762	816	870	924	978	1036	1090	1144	1199	1253
2700	449	505	561	617	674	730	790	846	902	959	1015	1075	1131	1187	1243	1300
3000	472	531	591	650	709	769	831	891	950	1009	1068	1131	1190	1250	1309	1368
3200	488	550	611	672	734	795	860	921	982	1044	1105	1170	1231	1292	1354	1415
3400	510	574	638	701	766	830	897	961	1025	1089	1153	1220	1284	1348	1412	1476

← width (mm)

SCREEN Standard 90° 85 mm, side guidance - bottom beam in side guides

up to	1000	1200	1400	1600	1800	2000	2200	2400	2600	2800	3000
1000	233	262	292	321	351	380	409	438	468	497	526
1200	249	280	312	343	374	406	437	468	500	531	563
1500	273	307	341	376	410	445	479	513	548	582	616
1700	289	325	361	398	434	471	507	544	580	617	653

↑ height (mm)

**Remarks and surcharges**

- net prices - TAX should be added.
- standard colours are: 01 silver RAL 9006, 08B dark brown 8019 \*, 09B brown 8014 \*, 15 cream white 9001 \*, 20B black 9005 \*, 22B ultra white 9016 \*, 23B gray anthracite 7016 \*, 34B quartz gray 7039 \*, 37B gray aluminum (\* - similar to colours with this number from the RAL palette).
- for an additional fee, varnishing in any colour from the RAL palette possible (extended lead time).

BOX varnishing in RAL colour	22,00 € / pc.
guides varnishing in RAL colour	13,75 € / set
bottom beam varnishing in RAL colour	8,25 € / pc.

**Standard system.** SCREEN in top-mounted box, ZIP SCREEN guidance system.



**GUIDANCE SCHEME**

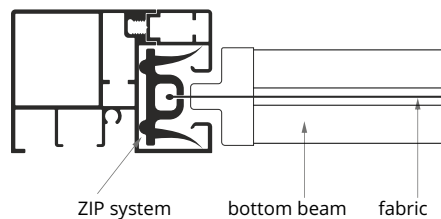

**CASSETTE**

- cassette made of PVC, occurs in three sizes.
- the maximum dimensions of shield for each of the cassette are given in a table on page 8<sup>th</sup>.

**FABRIC**

- high-quality fabrics made of plastics (glass fiber, PVC) from the best European producers guarantee resistance to weather conditions and a long useful life.

**ZIP SCREEN GUIDANCE**

- "ZIP SCREEN" guidance is an innovative way of guidance where the lower beam and material move inside the guides. This enables the perfect tension of the material, increases the resistance of the shield to difficult weather conditions, and additionally, when the shield is fully lowered, it fulfills a protective function, e.g. against dirt or insects.

**DRIVE**

- SCREEN Standard shields are offered only with an electric motor.
- the prices in the table do not include the price of the electric motor, it should be added. Price list of available drives on pages 32 - 33.

**COLOURS**

- standard colour of box and revision flap is white RAL 9016, standard colours of side guides are: 02 white RAL 9016, 08 dark brown RAL 8019, 23 gray anthracite RAL 7016.
- colours of box and revision flap for an additional fee are: anthracite 701605 (renolit), mahogany 2065021 (renolit), walnut 2178007 (renolit), golden oak 2178001 (renolit).
- for a special request and for an additional fee, varnishing in any colour from the RAL palette possible (extended lead time).
- fabrics - according to the current pattern book.

**SIDE GUIDES**

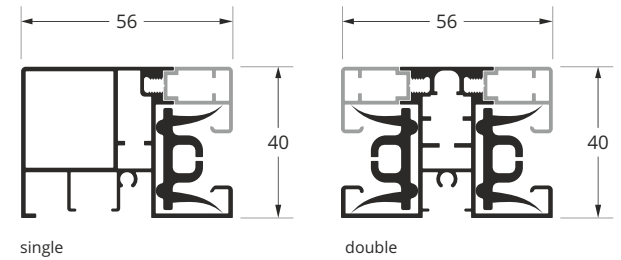

**BOTTOM BEAM**

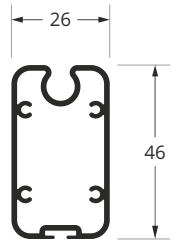

**CASSETTES**

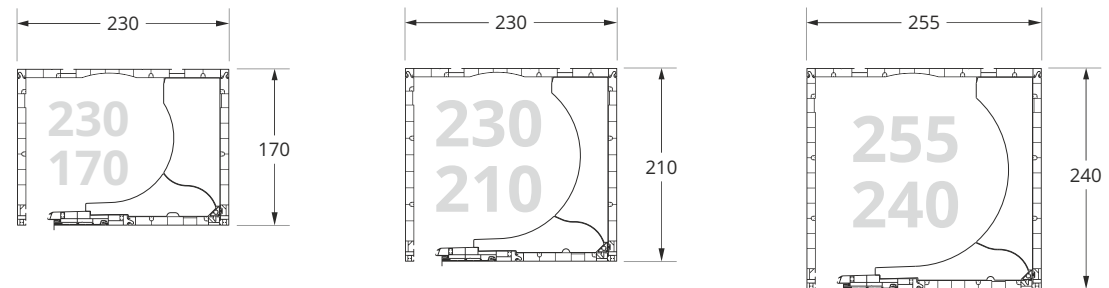

**Standard SCREEN in top-mounted recessed box, ZIP SCREEN guidance system**

up to	1000	1200	1400	1600	1800	2000	2200	2400	2600	2800	3000	3200	3400	3600	3800	4000
1000	345	382	419	455	493	529	571	608	644	681	718	759	796	833	870	907
1200	364	402	439	478	515	554	596	634	672	710	748	790	828	866	904	942
1500	391	430	470	509	549	589	633	673	712	752	792	836	875	914	954	994
1700	409	450	491	532	572	613	658	698	740	780	821	866	906	948	988	1029
2000	436	478	521	564	606	649	695	737	780	822	865	911	953	996	1039	1081
2200	455	498	542	585	629	673	720	764	807	851	895	942	985	1029	1072	1116
2500	482	527	572	618	663	708	757	802	848	893	938	987	1032	1078	1123	1168
2700	500	547	593	639	686	732	782	829	875	921	968	1018	1064	1110	1157	1203
3000	528	576	623	672	720	767	820	867	915	964	1011	1063	1111	1159	1207	1255
3200	546	595	644	693	743	792	845	894	943	992	1041	1094	1143	1192	1241	1290
3500	574	624	676	726	777	828	883	934	984	1036	1087	1141	1192	1243	1293	1344
3700	592	644	695	747	799	851	907	958	1011	1062	1114	1170	1222	1273	1326	1377
4000	619	672	726	779	833	887	944	997	1051	1104	1158	1215	1269	1322		
4200	638	692	747	802	856	911	969	1023	1078	1133	1188	1246	1300			
4500	665	721	777	834	890	946	1006	1062	1119	1175	1231	1291				
4700	683	741	798	855	913	970	1031	1088	1146	1203	1261					
5000	710	769	828	887	946	1005	1068	1127	1186	1245	1304					

↑ height (mm)

← width (mm)

**Surcharge - non-standard revision flap**

1000	1200	1400	1600	1800	2000	2200	2400	2600	2800	3000	3200	3400	3600	3800	4000
8	9	11	13	15	17	19	21	23	24	26	28	30	32	34	36

**Surcharge - non-standard external part**

1000	1200	1400	1600	1800	2000	2200	2400	2600	2800	3000	3200	3400	3600	3800	4000
11	14	17	19	22	25	28	30	33	36	39	41	44	47	50	52

**Surcharge - non-standard internal part**

1000	1200	1400	1600	1800	2000	2200	2400	2600	2800	3000	3200	3400	3600	3800	4000
11	14	17	19	22	25	28	30	33	36	39	41	44	47	50	52

**Surcharge - Steel reinforcements of frontal and bottom profile**

1000	1200	1400	1600	1800	2000	2200	2400	2600	2800	3000	3200	3400	3600	3800	4000
9	11	14	16	19	21	23	26	28	30	33	35	38	40	42	45

**Remarks and surcharges**

- net prices - TAX should be added.
- standard colour of box and revision flap is: white RAL 9016.
- colours of box and revision flap for an additional fee are: anthracite 701605 (renolit), mahogany 2065021 (renolit), walnut 2178007 (renolit), golden oak 2178001 (renolit).
- standard colours of side guides are: 02 white RAL 9016, 08 dark brown RAL 8019, 23 gray anthracite RAL 7016.
- for an additional fee, varnishing in any colour from the RAL palette possible (extended lead time).

guides varnishing in RAL colour	13,75 € / set
bottom beam varnishing in RAL colour	8,25 € / pc.

**Standard SCREEN in top-mounted recessed box, ZIP SCREEN guidance system**

up to	1000	1200	1400	1600	1800	2000	2200	2400	2600	2800	3000	3200	3400	3600	3800	4000
1000	351	389	427	465	504	542	584	622	660	698	736	779	817	855	893	932
1200	371	410	450	489	528	568	612	651	691	730	770	813	853	892	932	972
1500	400	441	483	524	566	607	653	695	736	778	819	865	906	947	989	1031
1700	420	462	505	548	591	634	681	723	767	809	852	899	942	985	1028	1071
2000	448	493	538	583	628	673	722	767	812	856	901	950	995	1040	1085	1130
2200	468	514	561	607	653	700	750	796	842	888	935	985	1031	1077	1123	1170
2500	497	545	594	642	690	739	791	839	887	936	984	1036	1084	1133	1181	1229
2700	517	567	616	666	716	765	819	868	918	967	1017	1071	1120	1170	1220	1269
3000	546	598	649	701	753	804	860	911	963	1015	1066	1122	1174	1225	1277	1328
3200	566	619	672	725	778	831	888	940	994	1047	1100	1157	1209	1262	1315	1368
3500	595	649	705	759	815	870	929	984	1038	1094	1149	1207	1263	1318	1372	1427
3700	614	671	727	784	840	896	956	1013	1069	1126	1182	1242	1299	1355	1411	1468
4000	643	702	760	819	877	936	998	1056	1114	1173	1231	1293	1352	1410		
4200	663	723	783	843	902	962	1025	1085	1145	1205	1265	1328	1388			
4500	692	754	816	878	939	1001	1067	1128	1190	1252	1313	1379				
4700	712	775	838	901	965	1027	1094	1157	1221	1283	1347					
5000	741	806	871	936	1001	1066	1136	1201	1265	1331	1396					

height (mm)

width (mm)

**Surcharge - non-standard revision flap**

1000	1200	1400	1600	1800	2000	2200	2400	2600	2800	3000	3200	3400	3600	3800	4000
8	9	11	13	15	17	19	21	23	24	26	28	30	32	34	36

**Surcharge - non-standard external part**

1000	1200	1400	1600	1800	2000	2200	2400	2600	2800	3000	3200	3400	3600	3800	4000
11	14	17	19	22	25	28	30	33	36	39	41	44	47	50	52

**Surcharge - non-standard internal part**

1000	1200	1400	1600	1800	2000	2200	2400	2600	2800	3000	3200	3400	3600	3800	4000
11	14	17	19	22	25	28	30	33	36	39	41	44	47	50	52

**Surcharge - Steel reinforcements of frontal and bottom profile**

1000	1200	1400	1600	1800	2000	2200	2400	2600	2800	3000	3200	3400	3600	3800	4000
9	11	14	16	19	21	23	26	28	30	33	35	38	40	42	45

**Remarks and surcharges**

- net prices - TAX should be added.
- standard colour of box and revision flap is: white RAL 9016.
- colours of box and revision flap for an additional fee are: anthracite 701605 (renolit), mahogany 2065021 (renolit), walnut 2178007 (renolit), golden oak 2178001 (renolit).
- standard colours of side guides are: 02 white RAL 9016, 08 dark brown RAL 8019, 23 gray anthracite RAL 7016.
- for an additional fee, varnishing in any colour from the RAL palette possible (extended lead time).

guides varnishing in RAL colour	13,75 € / set
bottom beam varnishing in RAL colour	8,25 € / pc.

**Standard SCREEN in top-mounted recessed box, ZIP SCREEN guidance system**

up to	1000	1200	1400	1600	1800	2000	2200	2400	2600	2800	3000	3200	3400	3600	3800	4000
1000	371	413	455	497	539	581	628	670	712	754	796	842	884	926	968	1011
1200	395	439	483	527	571	616	664	708	753	797	841	889	934	978	1022	1066
1500	429	477	524	572	619	667	718	766	813	861	908	960	1007	1054	1102	1149
1700	453	503	552	602	651	701	755	804	854	904	953	1007	1056	1106	1156	1205
2000	488	540	594	647	699	752	809	862	914	967	1020	1077	1129	1182	1235	1288
2200	512	567	622	676	731	787	845	900	956	1010	1065	1124	1179	1234	1289	1344
2500	546	605	663	721	779	838	899	958	1016	1074	1132	1194	1252	1311	1369	1427
2700	570	631	691	751	812	872	936	996	1057	1117	1177	1241	1302	1362	1423	1483
3000	605	669	732	796	859	923	990	1054	1117	1181	1244	1312	1375	1439	1502	1566
3200	629	695	760	826	892	957	1027	1092	1158	1224	1289	1359	1424	1490	1556	1622
3500	662	730	799	867	936	1004	1077	1145	1213	1282	1351	1423	1491	1560	1628	1696
3700	687	759	829	901	972	1043	1117	1188	1260	1330	1401	1476	1547	1618	1689	1760
4000	722	796	871	945	1019	1094	1172	1246	1320	1394	1468	1546	1621	1695		
4200	746	822	899	976	1052	1128	1208	1284	1361	1437	1514	1594	1670			
4500	781	860	940	1020	1099	1179	1262	1342	1421	1501	1580	1664				
4700	805	887	968	1050	1132	1213	1299	1380	1462	1544	1626					
5000	839	924	1010	1094	1179	1264	1353	1438	1523	1608	1693					

height (mm)

width (mm)

**Surcharge - non-standard revision flap**

1000	1200	1400	1600	1800	2000	2200	2400	2600	2800	3000	3200	3400	3600	3800	4000
8	9	11	13	15	17	19	21	23	24	26	28	30	32	34	36

**Surcharge - non-standard external part**

1000	1200	1400	1600	1800	2000	2200	2400	2600	2800	3000	3200	3400	3600	3800	4000
11	14	17	19	22	25	28	30	33	36	39	41	44	47	50	52

**Surcharge - non-standard internal part**

1000	1200	1400	1600	1800	2000	2200	2400	2600	2800	3000	3200	3400	3600	3800	4000
11	14	17	19	22	25	28	30	33	36	39	41	44	47	50	52

**Surcharge - Steel reinforcements of frontal and bottom profile**

1000	1200	1400	1600	1800	2000	2200	2400	2600	2800	3000	3200	3400	3600	3800	4000
9	11	14	16	19	21	23	26	28	30	33	35	38	40	42	45

**Remarks and surcharges**

- net prices - TAX should be added.
- standard colour of box and revision flap is: white RAL 9016.
- colours of box and revision flap for an additional fee are: anthracite 701605 (renolit), mahogany 2065021 (renolit), walnut 2178007 (renolit), golden oak 2178001 (renolit).
- standard colours of side guides are: 02 white RAL 9016, 08 dark brown RAL 8019, 23 gray anthracite RAL 7016.
- for an additional fee, varnishing in any colour from the RAL palette possible (extended lead time).

guides varnishing in RAL colour	13,75 € / set
bottom beam varnishing in RAL colour	8,25 € / pc.



**GUIDANCE SCHEME**

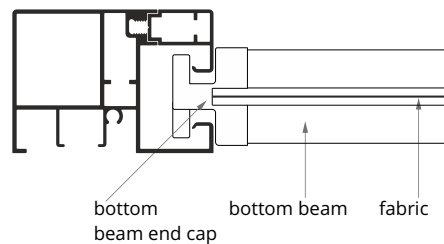

**CASSETTE**

- cassette made of PVC, occurs in three sizes.
- the maximum dimensions of shield for each of the cassette are given in a table on page 8<sup>th</sup>.

**FABRIC**

- high-quality fabrics made of plastics (glass fiber, PVC) from the best European producers guarantee resistance to weather conditions and a long usefull life.

**GUIDANCE - BOTTOM BEAM IN SIDE GUIDES**

- bottom beam in side guides - the fabric is not recessed in the guides, only the bottom beam is guided inside them.

**DRIVE**

- SCREEN Standard shields are offered only with an electric motor.
- the prices in the table do not include the price of the electric motor, it should be added. Price list of available drives on pages 32 - 33.

**COLOURS**

- standard colour of box and revision flap is white RAL 9016, standard colours of side guides are: 02 white RAL 9016, 08 dark brown RAL 8019, 23 gray anthracite RAL 7016.
- colours of box and revision flap for an additional fee are: anthracite 701605 (renolit), mahogany 2065021 (renolit), walnut 2178007 (renolit), golden oak 2178001 (renolit).
- for a special request and for an additional fee, varnishing in any colour from the RAL palette possible (extended lead time).
- fabrics - according to the current pattern book.

**SIDE GUIDES**

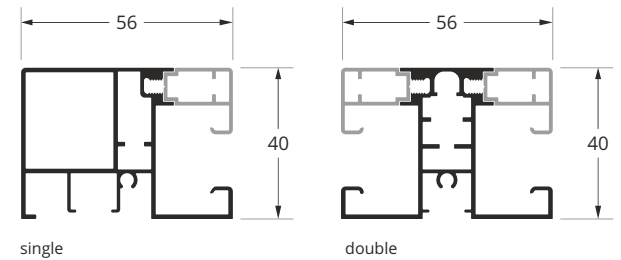

**BOTTOM BEAM**

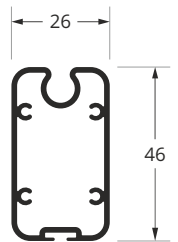

**CASSETTES**

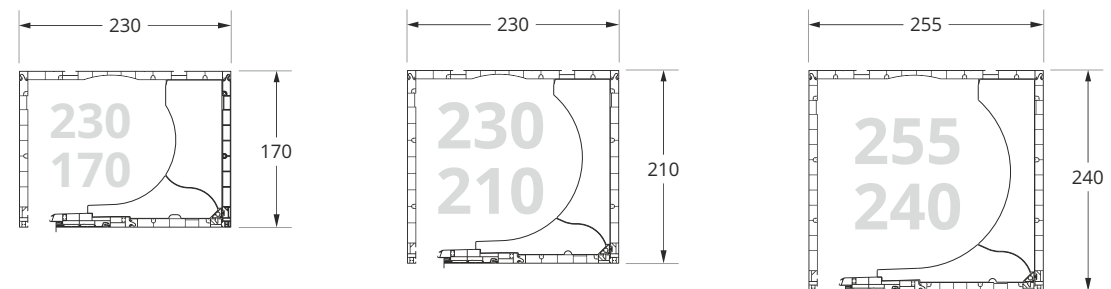



**Standard SCREEN in top-mounted recessed box, side guidance - bottom beam in side guides**

up to	1000	1200	1400	1600	1800	2000	2200	2400	2600	2800	3000	3200	3400	3600	3800	4000
1000	327	362	397	432	467	502	541	576	611	646	681	720	755	791	825	861
1200	345	381	417	453	489	525	565	601	638	673	709	749	785	821	857	894
1500	371	408	446	483	521	559	600	638	675	713	751	792	830	867	905	942
1700	388	427	465	504	543	581	624	662	701	740	778	821	859	898	937	975
2000	414	454	494	535	575	615	659	699	739	779	820	863	904	944	984	1025
2200	431	472	514	555	596	638	683	724	765	806	848	893	934	975	1016	1058
2500	457	500	543	586	628	671	718	760	803	846	889	935	978	1021	1064	1107
2700	475	519	562	606	650	694	742	785	829	873	917	964	1008	1052	1096	1140
3000	500	546	591	636	682	727	777	822	867	913	958	1007	1053	1098	1143	1189
3200	518	564	611	657	704	750	800	846	893	940	986	1036	1082	1129	1175	1222
3500	544	592	640	688	737	785	837	885	933	981	1029	1081	1129	1177	1225	1273
3700	561	610	659	708	757	806	859	908	957	1006	1055	1108	1157	1206	1255	1304
4000	587	637	688	739	789	840	894	945	995	1046	1096	1150	1201	1252		
4200	605	656	708	759	811	863	918	969	1021	1073	1124	1179	1231			
4500	630	683	736	790	843	896	953	1006	1059	1112	1165	1222				
4700	648	702	756	810	865	919	976	1031	1085	1139	1193					
5000	673	729	785	840	896	952	1012	1067	1123	1179	1235					

↑ height (mm)

← width (mm)

**Surcharge - non-standard revision flap**

1000	1200	1400	1600	1800	2000	2200	2400	2600	2800	3000	3200	3400	3600	3800	4000
8	9	11	13	15	17	19	21	23	24	26	28	30	32	34	36

**Surcharge - non-standard external part**

1000	1200	1400	1600	1800	2000	2200	2400	2600	2800	3000	3200	3400	3600	3800	4000
11	14	17	19	22	25	28	30	33	36	39	41	44	47	50	52

**Surcharge - non-standard internal part**

1000	1200	1400	1600	1800	2000	2200	2400	2600	2800	3000	3200	3400	3600	3800	4000
11	14	17	19	22	25	28	30	33	36	39	41	44	47	50	52

**Surcharge - Steel reinforcements of frontal and bottom profile**

1000	1200	1400	1600	1800	2000	2200	2400	2600	2800	3000	3200	3400	3600	3800	4000
9	11	14	16	19	21	23	26	28	30	33	35	38	40	42	45

**Remarks and surcharges**

- net prices - TAX should be added.
- standard colour of box and revision flap is: white RAL 9016.
- colours of box and revision flap for an additional fee are: anthracite 701605 (renolit), mahogany 2065021 (renolit), walnut 2178007 (renolit), golden oak 2178001 (renolit).
- standard colours of side guides are: 02 white RAL 9016, 08 dark brown RAL 8019, 23 gray anthracite RAL 7016.
- for an additional fee, varnishing in any colour from the RAL palette possible (extended lead time).

guides varnishing in RAL colour	13,75 € / set
bottom beam varnishing in RAL colour	8,25 € / pc.

**Standard SCREEN in top-mounted recessed box, side guidance - bottom beam in side guides**

up to	1000	1200	1400	1600	1800	2000	2200	2400	2600	2800	3000	3200	3400	3600	3800	4000
1000	333	370	406	442	478	515	555	591	627	664	700	740	776	813	849	885
1200	352	390	427	465	502	540	581	619	657	694	731	772	810	848	885	923
1500	380	419	459	498	538	577	620	660	699	739	778	822	861	900	940	979
1700	399	439	480	521	561	602	647	687	728	769	809	854	895	936	977	1017
2000	426	468	511	554	597	639	686	728	771	814	856	903	945	988	1031	1074
2200	445	489	533	576	620	665	712	756	800	844	888	936	979	1023	1067	1111
2500	472	518	564	610	656	702	751	797	843	889	935	984	1030	1076	1122	1168
2700	491	538	586	632	680	727	778	825	872	919	966	1017	1064	1111	1159	1206
3000	519	568	617	666	715	764	817	866	915	964	1013	1066	1115	1164	1213	1262
3200	538	588	638	688	739	789	843	893	944	994	1045	1099	1149	1199	1250	1300
3500	565	617	670	721	774	827	882	935	987	1039	1091	1147	1200	1252	1304	1356
3700	584	637	691	744	798	851	909	962	1016	1069	1123	1180	1234	1287	1341	1394
4000	611	666	722	778	833	889	948	1003	1059	1114	1170	1229	1284	1340		
4200	630	687	744	801	857	914	974	1031	1087	1144	1201	1262	1318			
4500	658	716	775	834	892	951	1013	1072	1131	1189	1248	1310				
4700	676	736	796	856	916	976	1039	1099	1160	1219	1280					
5000	704	765	828	889	951	1013	1079	1141	1202	1264	1326					

height (mm)

width (mm)

**Surcharge - non-standard revision flap**

1000	1200	1400	1600	1800	2000	2200	2400	2600	2800	3000	3200	3400	3600	3800	4000
8	9	11	13	15	17	19	21	23	24	26	28	30	32	34	36

**Surcharge - non-standard external part**

1000	1200	1400	1600	1800	2000	2200	2400	2600	2800	3000	3200	3400	3600	3800	4000
11	14	17	19	22	25	28	30	33	36	39	41	44	47	50	52

**Surcharge - non-standard internal part**

1000	1200	1400	1600	1800	2000	2200	2400	2600	2800	3000	3200	3400	3600	3800	4000
11	14	17	19	22	25	28	30	33	36	39	41	44	47	50	52

**Surcharge - Steel reinforcements of frontal and bottom profile**

1000	1200	1400	1600	1800	2000	2200	2400	2600	2800	3000	3200	3400	3600	3800	4000
9	11	14	16	19	21	23	26	28	30	33	35	38	40	42	45

**Remarks and surcharges**

- net prices - TAX should be added.
- standard colour of box and revision flap is: white RAL 9016.
- colours of box and revision flap for an additional fee are: anthracite 701605 (renolit), mahogany 2065021 (renolit), walnut 2178007 (renolit), golden oak 2178001 (renolit).
- standard colours of side guides are: 02 white RAL 9016, 08 dark brown RAL 8019, 23 gray anthracite RAL 7016.
- for an additional fee, varnishing in any colour from the RAL palette possible (extended lead time).

guides varnishing in RAL colour	13,75 € / set
bottom beam varnishing in RAL colour	8,25 € / pc.

**Standard SCREEN in top-mounted recessed box, side guidance - bottom beam in side guides**

up to	1000	1200	1400	1600	1800	2000	2200	2400	2600	2800	3000	3200	3400	3600	3800	4000
1000	353	393	434	473	514	554	598	639	679	719	759	803	843	884	924	964
1200	376	418	460	503	545	587	633	676	718	760	803	848	891	933	975	1018
1500	409	455	500	545	591	636	685	731	776	822	867	917	962	1007	1052	1098
1700	432	480	527	575	622	669	721	768	816	863	910	962	1009	1057	1104	1151
2000	465	516	567	617	668	718	773	823	874	924	975	1029	1080	1130	1181	1232
2200	488	541	594	646	699	752	808	860	913	966	1019	1075	1127	1180	1233	1285
2500	522	577	633	689	745	801	860	916	971	1027	1083	1142	1198	1254	1310	1366
2700	544	602	660	718	776	833	895	953	1011	1068	1126	1188	1246	1303	1362	1419
3000	578	639	700	761	822	882	947	1008	1069	1130	1191	1256	1317	1378	1438	1499
3200	601	664	727	790	853	916	982	1045	1108	1172	1234	1301	1364	1427	1490	1553
3500	632	698	764	829	895	961	1030	1096	1161	1227	1293	1362	1428	1494	1559	1625
3700	657	725	793	862	930	998	1069	1138	1206	1274	1342	1414	1483	1550	1619	1687
4000	690	761	833	904	975	1047	1122	1193	1264	1335	1407	1482	1553	1624		
4200	713	786	860	933	1006	1080	1157	1230	1303	1377	1450	1527	1601			
4500	747	823	900	976	1052	1129	1209	1285	1362	1438	1515	1595				
4700	769	848	926	1005	1084	1162	1244	1323	1401	1480	1558					
5000	802	884	966	1047	1129	1211	1296	1378	1459	1541	1623					

↑ height (mm)

← width (mm)

**Surcharge - non-standard revision flap**

1000	1200	1400	1600	1800	2000	2200	2400	2600	2800	3000	3200	3400	3600	3800	4000
8	9	11	13	15	17	19	21	23	24	26	28	30	32	34	36

**Surcharge - non-standard external part**

1000	1200	1400	1600	1800	2000	2200	2400	2600	2800	3000	3200	3400	3600	3800	4000
11	14	17	19	22	25	28	30	33	36	39	41	44	47	50	52

**Surcharge - non-standard internal part**

1000	1200	1400	1600	1800	2000	2200	2400	2600	2800	3000	3200	3400	3600	3800	4000
11	14	17	19	22	25	28	30	33	36	39	41	44	47	50	52

**Surcharge - Steel reinforcements of frontal and bottom profile**

1000	1200	1400	1600	1800	2000	2200	2400	2600	2800	3000	3200	3400	3600	3800	4000
9	11	14	16	19	21	23	26	28	30	33	35	38	40	42	45

**Remarks and surcharges**

- net prices - TAX should be added.
- standard colour of box and revision flap is: white RAL 9016.
- colours of box and revision flap for an additional fee are: anthracite 701605 (renolit), mahogany 2065021 (renolit), walnut 2178007 (renolit), golden oak 2178001 (renolit).
- standard colours of side guides are: 02 white RAL 9016, 08 dark brown RAL 8019, 23 gray anthracite RAL 7016.
- for an additional fee, varnishing in any colour from the RAL palette possible (extended lead time).

guides varnishing in RAL colour	13,75 € / set
bottom beam varnishing in RAL colour	8,25 € / pc.



**GUIDANCE SCHEME**

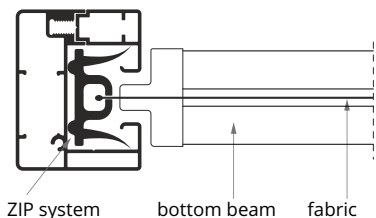

**CASSETTE**

- 90° cassette made of bent aluminium, occurs in three sizes.
- the maximum dimensions of shield for each of the cassette are given in a table on page 8<sup>th</sup>

**FABRIC**

- high-quality fabrics made of plastics (glass fiber, PVC) from the best European producers guarantee resistance to weather conditions and a long useful life.

**ZIP SCREEN GUIDANCE**

- "ZIP SCREEN" guidance is an innovative way of guidance where the lower beam and material move inside the guides. This enables the perfect tension of the material, increases the resistance of the shield to difficult weather conditions, and additionally, when the shield is fully lowered, it fulfills a protective function, e.g. against dirt or insects.

**DRIVE**

- SCREEN Basic shields are offered only with an electric motor.
- the prices in the table do not include the price of the electric motor, it should be added. Price list of available drives on pages 32 - 33.

**COLOURS**

- standard colours of side guides and bottom beam are: 01 silver RAL 9006, 09B brown 8014\*, 22B ultra white 9016\*, 23B gray anthracite RAL 7016\* (\* - similar to colours with this number from the RAL palette).
- for a special request and for an additional fee, varnishing in any colour from the RAL palette possible (extended lead time).
- fabrics - according to the current pattern book.

**SIDE GUIDES**

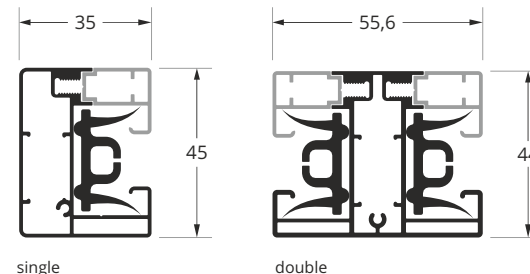

**BOTTOM BEAM**

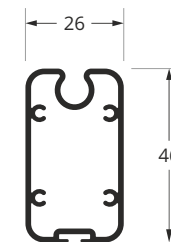

**CASSETTES**

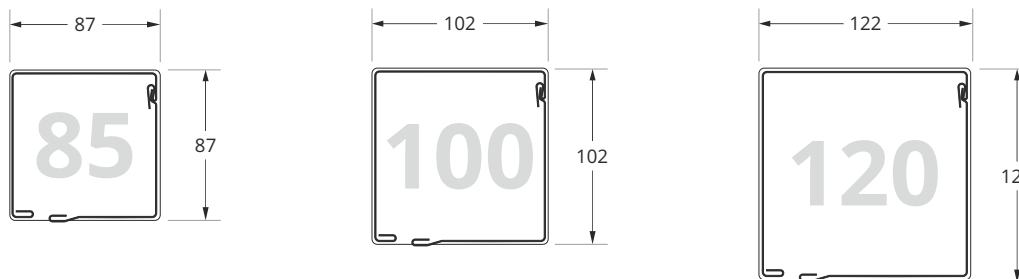

**Basic 90° SCREEN, 100 or 120 mm, ZIP SCREEN guidance system**

up to	1000	1200	1400	1600	1800	2000	2200	2400	2600	2800	3000
1000	299	331	363	395	427	459	494	526	558	590	622
1200	315	348	381	414	447	479	516	549	582	614	647
1500	338	373	407	441	475	510	547	582	616	650	685
1700	354	390	425	460	495	530	569	604	639	675	710
2000	377	414	451	488	524	561	601	637	674	711	747
2200	393	431	469	506	543	581	622	660	697	735	772
2500	417	456	495	534	573	612	654	693	732	771	810
2700	433	473	513	553	593	632	676	715	755	795	835
3000	456	497	539	580	621	663	707	749	790	831	872
3200	472	514	557	599	641	683	729	771	813	855	897
3500	496	540	584	627	671	715	762	806	849	893	936
3700	511	556	601	645	690	734	782	826	871	915	960
4000	535	581	627	672	718	765	814	860	905	951	997
4200	551	598	645	691	738	785	835	882	928	975	1022
4500	574	622	671	719	767	815	867	915	963	1011	1060
4700	590	639	689	738	787	836	888	938	987	1036	1085
5000	613	664	715	765	816	866	920	971	1021	1072	1122

← width (mm)

**Basic 90° SCREEN 85 mm, ZIP SCREEN guidance system**

up to	1000	1200	1400	1600	1800	2000	2200	2400	2600	2800	3000
1000	233	256	279	301	324	347	370	392	415	438	461
1200	249	272	296	320	344	367	391	415	439	462	486
1500	272	297	322	348	373	398	423	448	473	498	523
1700	288	314	340	366	392	418	445	470	496	522	549

↑ height (mm)

**Remarks and surcharges**

- net prices - TAX should be added.
- standard colours of side guides and bottom beam are: 01 silver RAL 9006, 09B brown 8014\*, 22B ultra white 9016\*, 23B gray anthracite RAL 7016\* (\* - similar to colours with this number from the RAL palette).
- for an additional fee, varnishing in any colour from the RAL palette possible (extended lead time).

BOX varnishing in RAL colour	22,00 € / pc.
guides varnishing in RAL colour	13,75 € / set
bottom beam varnishing in RAL colour	8,25 € / pc.

**Basic 90° SCREEN, 100 or 120 mm, ZIP SCREEN guidance system**

up to	1000	1200	1400	1600	1800	2000	2200	2400	2600	2800	3000
1000	305	338	371	405	438	471	508	541	574	607	640
1200	322	357	391	425	460	494	532	566	601	635	669
1500	347	384	420	456	492	528	567	604	640	676	712
1700	365	402	439	477	514	551	592	629	666	704	741
2000	390	429	468	507	546	585	628	667	706	745	784
2200	407	447	487	527	568	608	652	692	732	773	813
2500	432	474	516	558	600	642	687	730	771	813	856
2700	450	493	536	579	622	665	712	755	798	841	885
3000	475	519	565	609	654	699	747	793	837	882	927
3200	492	538	584	630	676	722	772	818	864	910	956
3500	517	565	613	660	709	756	808	856	903	951	999
3700	534	583	632	681	730	779	832	881	930	979	1028
4000	559	610	661	712	762	813	867	918	969	1020	1070
4200	577	629	681	732	785	837	892	943	995	1047	1099
4500	602	655	709	763	816	870	927	981	1035	1088	1142
4700	619	674	729	784	838	893	951	1006	1061	1116	1171
5000	644	701	757	814	871	927	987	1044	1101	1157	1214

← width (mm)

**Basic 90° SCREEN 85 mm, ZIP SCREEN guidance system**

up to	1000	1200	1400	1600	1800	2000	2200	2400	2600	2800	3000
1000	239	263	287	311	335	359	383	407	431	455	479
1200	256	281	307	332	357	382	407	433	458	483	508
1500	281	308	335	362	389	416	443	470	497	524	551
1700	299	327	355	383	411	439	468	495	523	552	580

↑ height (mm)

**Remarks and surcharges**

- net prices - TAX should be added.
- standard colours of side guides and bottom beam are: 01 silver RAL 9006, 09B brown 8014\*, 22B ultra white 9016\*, 23B gray anthracite RAL 7016\* (\* - similar to colours with this number from the RAL palette).
- for an additional fee, varnishing in any colour from the RAL palette possible (extended lead time).

BOX varnishing in RAL colour	22,00 € / pc.
guides varnishing in RAL colour	13,75 € / set
bottom beam varnishing in RAL colour	8,25 € / pc.

**Basic 90° SCREEN, 100 or 120 mm, ZIP SCREEN guidance system**

up to	1000	1200	1400	1600	1800	2000	2200	2400	2600	2800	3000
1000	325	362	399	436	474	510	551	588	625	663	700
1200	346	385	424	463	503	541	584	623	662	701	740
1500	377	419	461	503	545	587	633	675	717	759	801
1700	398	442	486	530	574	618	666	710	754	798	842
2000	429	476	523	570	617	664	715	762	808	856	903
2200	450	499	548	597	646	695	748	796	845	894	943
2500	482	533	585	637	689	741	796	848	900	952	1004
2700	503	557	611	664	718	772	829	883	937	991	1045
3000	534	591	648	704	761	818	878	935	992	1049	1105
3200	555	614	673	731	790	849	911	969	1028	1087	1146
3500	584	646	707	768	830	891	955	1017	1078	1139	1200
3700	607	671	735	798	862	926	993	1056	1120	1183	1247
4000	639	705	772	838	905	972	1041	1108	1175	1241	1308
4200	660	728	797	865	934	1003	1074	1143	1211	1280	1348
4500	691	762	834	905	977	1048	1123	1195	1266	1337	1409
4700	712	785	859	932	1006	1079	1156	1229	1303	1376	1450
5000	743	819	896	972	1049	1125	1205	1281	1358	1434	1510

← width (mm)

**Basic 90° SCREEN 85 mm, ZIP SCREEN guidance system**

up to	1000	1200	1400	1600	1800	2000	2200	2400	2600	2800	3000
1000	259	287	315	343	371	399	427	454	483	511	539
1200	280	310	340	370	400	430	459	490	519	549	579
1500	311	344	377	410	443	475	508	541	574	607	640
1700	332	367	402	437	472	506	541	576	611	646	681

↑ height (mm)

**Remarks and surcharges**

- net prices - TAX should be added.
- standard colours of side guides and bottom beam are: 01 silver RAL 9006, 09B brown 8014\*, 22B ultra white 9016\*, 23B gray anthracite RAL 7016\* (\* - similar to colours with this number from the RAL palette).
- for an additional fee, varnishing in any colour from the RAL palette possible (extended lead time).

BOX varnishing in RAL colour	22,00 € / pc.
guides varnishing in RAL colour	13,75 € / set
bottom beam varnishing in RAL colour	8,25 € / pc.



**GUIDANCE SCHEME**

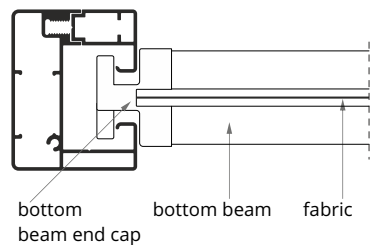

**CASSETTE**

- 90° cassette made of bent aluminium, occurs in three sizes.  
 - the maximum dimensions of shield for each of the cassette are given in a table on page 8<sup>th</sup>

**FABRIC**

- high-quality fabrics made of plastics (glass fiber, PVC) from the best European producers guarantee resistance to weather conditions and a long useful life.

**GUIDANCE - BOTTOM BEAM IN SIDE GUIDES**

- bottom beam in side guides - the fabric is not recessed in the guides, only the bottom beam is guided inside them.

**DRIVE**

- SCREEN Basic shields are offered only with an electric motor.  
 - the prices in the table do not include the price of the electric motor, it should be added. Price list of available drives on pages 32 - 33.

**COLOURS**

- standard colours of side guides and bottom beam are: 01 silver RAL 9006, 09B brown 8014\*, 22B ultra white 9016\*, 23B gray anthracite RAL 7016\* (\* - similar to colours with this number from the RAL palette).  
 - for a special request and for an additional fee, varnishing in any colour from the RAL palette possible (extended lead time).  
 - fabrics - according to the current pattern book.

**SIDE GUIDES**

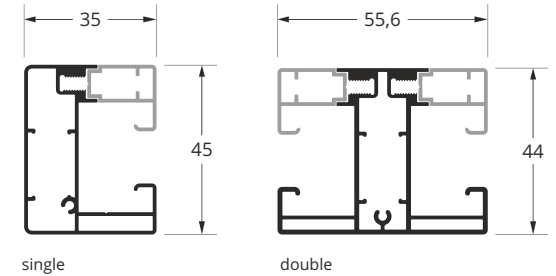

**BOTTOM BEAM**

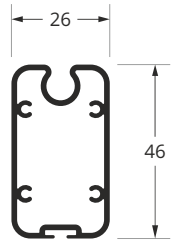

**CASSETTES**

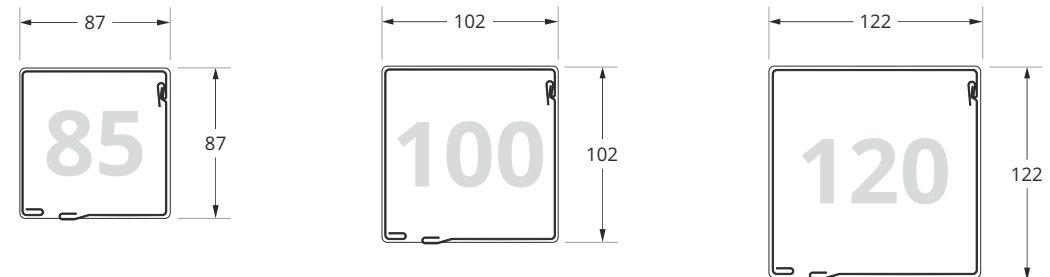



**Basic 90° SCREEN, 100 or 120 mm, ZIP SCREEN guidance system in side guides**

	1000	1200	1400	1600	1800	2000	2200	2400	2600	2800	3000
1000	273	305	337	370	401	433	469	501	532	564	596
1200	284	316	349	382	415	448	484	518	550	583	616
1500	298	333	367	401	435	470	507	542	576	610	645
1700	308	344	379	414	449	484	523	558	593	629	664
2000	323	360	397	433	469	506	546	583	620	656	693
2200	333	371	408	446	484	521	562	600	637	674	712
2500	348	387	426	465	504	543	585	624	663	702	740
2700	358	398	438	478	518	557	601	641	680	720	760
3000	373	414	455	497	538	579	624	665	706	747	789
3200	383	425	468	510	552	594	640	682	724	766	808
3400	399	442	486	529	573	617	664	708	751	795	839

← width (mm)

**Basic 90° SCREEN, 85 mm, side guidance - bottom beam in side guides**

	1000	1200	1400	1600	1800	2000	2200	2400	2600	2800	3000
1000	196	219	242	264	287	310	333	356	378	401	424
1200	206	230	254	277	301	325	349	372	396	420	444
1500	221	246	271	297	321	347	372	397	422	447	472
1700	231	257	283	309	335	361	388	414	440	466	492

↑ height (mm)

**Remarks and surcharges**

- net prices - TAX should be added.
- standard colours of side guides and bottom beam are: 01 silver RAL 9006, 09B brown 8014\*, 22B ultra white 9016\*, 23B gray anthracite RAL 7016\* (\* - similar to colours with this number from the RAL palette).
- for an additional fee, varnishing in any colour from the RAL palette possible (extended lead time).

BOX varnishing in RAL colour	22,00 € / pc.
guides varnishing in RAL colour	13,75 € / set
bottom beam varnishing in RAL colour	8,25 € / pc.

Basic 90° SCREEN, 100 or 120 mm, side guidance - bottom beam in side guides

	1000	1200	1400	1600	1800	2000	2200	2400	2600	2800	3000
1000	279	313	346	379	412	445	482	515	548	581	615
1200	291	325	360	394	428	463	501	535	569	603	638
1500	307	344	380	416	452	488	527	564	600	636	672
1700	319	356	393	431	468	505	546	583	620	658	695
2000	336	375	414	453	491	531	573	612	651	690	729
2200	347	387	427	468	508	548	591	632	672	712	752
2500	363	405	447	489	531	573	619	661	703	745	786
2700	375	418	461	504	547	590	637	680	723	767	810
3000	391	436	481	526	571	616	664	709	754	799	844
3200	402	449	495	541	587	633	683	729	775	821	867
3400	420	467	515	563	611	658	710	757	805	853	901

← width (mm)

Basic 90° SCREEN, 85 mm, side guidance - bottom beam in side guides

	1000	1200	1400	1600	1800	2000	2200	2400	2600	2800	3000
1000	202	226	250	274	298	322	346	370	394	418	442
1200	214	239	264	289	314	340	365	390	415	440	466
1500	230	257	284	311	338	365	392	419	446	473	500
1700	242	270	298	326	354	382	410	439	467	495	523

↑ wysokość (mm)

Remarks and surcharges

- net prices - TAX should be added.
- standard colours of side guides and bottom beam are: 01 silver RAL 9006, 09B brown 8014\*, 22B ultra white 9016\*, 23B gray anthracite RAL 7016\* (\* - similar to colours with this number from the RAL palette).
- for an additional fee, varnishing in any colour from the RAL palette possible (extended lead time).

BOX varnishing in RAL colour	22,00 € / pc.
guides varnishing in RAL colour	13,75 € / set
bottom beam varnishing in RAL colour	8,25 € / pc.

Basic 90° SCREEN, 100 or 120 mm, side guidance - bottom beam in side guides

up to	1000	1200	1400	1600	1800	2000	2200	2400	2600	2800	3000
1000	299	336	374	411	448	485	526	563	600	637	674
1200	315	353	393	432	471	510	553	592	631	670	709
1500	337	379	421	463	505	547	593	635	677	719	761
1700	352	396	440	485	529	572	620	664	708	752	796
2000	375	422	469	516	563	610	660	707	754	801	848
2200	390	439	488	537	586	635	687	736	785	834	883
2500	413	465	516	568	620	672	727	779	831	883	935
2700	428	482	536	589	643	697	755	809	862	916	970
3000	451	507	564	621	678	735	795	851	908	965	1022
3200	466	525	583	642	701	760	822	881	939	998	1057
3400	487	548	609	670	732	793	858	919	980	1041	1103

← width (mm)

Basic 90° SCREEN, 85 mm, side guidance - bottom beam in side guides

up to	1000	1200	1400	1600	1800	2000	2200	2400	2600	2800	3000
1000	222	250	278	306	334	362	390	418	446	474	502
1200	237	267	297	327	357	387	417	447	477	507	537
1500	260	293	326	359	391	424	457	490	523	556	589
1700	275	310	345	380	414	449	484	519	554	589	624

↑ height (mm)

Remarks and surcharges

- net prices - TAX should be added.
- standard colours of side guides and bottom beam are: 01 silver RAL 9006, 09B brown 8014\*, 22B ultra white 9016\*, 23B gray anthracite RAL 7016\* (\* - similar to colours with this number from the RAL palette).
- for an additional fee, varnishing in any colour from the RAL palette possible (extended lead time).

BOX varnishing in RAL colour	22,00 € / pc.
guides varnishing in RAL colour	13,75 € / set
bottom beam varnishing in RAL colour	8,25 € / pc.

## Basic SPR system. SCREEN in a bent surface-mounted box, controlled by spring.



GUIDANCE SCHEME

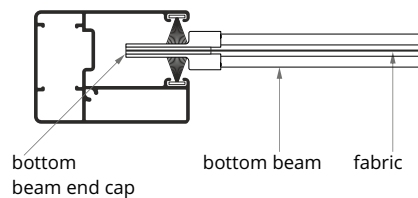

### CASSETTE

- 90° cassette made of bent aluminium, occurs in three sizes.
- the maximum dimensions of shield for each of the cassette are given in a table on page 8<sup>th</sup>.

### FABRIC

- high-quality fabrics made of plastics (glass fiber, PVC) from the best European producers guarantee resistance to weather conditions and a long useful life.

### GUIDANCE - BOTTOM BEAM AND FABRIC IN SIDE GUIDES

- bottom beam and fabric are recessed in the guides and move inside them.

### DRIVE

- manual control by spring system.
- an intuitive mechanism for convenient closing and opening AluClick.
- the price of the blind includes a complete mechanism.

### COLOURS

- standard colours of side guides and bottom beam are: 01 silver RAL 9006, 09B brown 8014\*, 22B ultra white 9016\*, 23B gray anthracite RAL 7016\* (\* - similar to colours with this number from the RAL palette).
- for a special request and for an additional fee, varnishing in any colour from the RAL palette possible (extended lead time).
- fabrics - according to the current pattern book.

### SIDE GUIDES

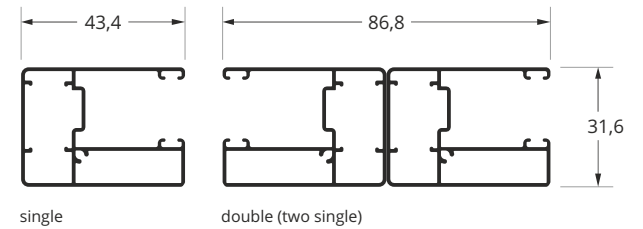

### STANDARD BOTTOM BEAM

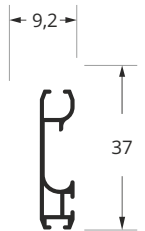

### CASSETTES

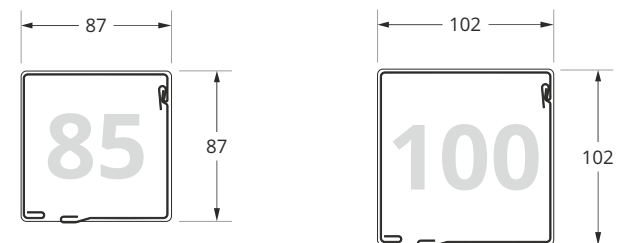

Standard 90° SCREEN, 85 or 100 mm with spring control, fabric guidance in side guides

up to	700	800	900	1000	1100	1200	1300	1400	1500	1600	1700	1800	1900	2000
700	236	240	245	251	255	261	265	271	275	280	285	290	296	300
800	243	248	253	258	263	269	274	279	284	289	294	299	305	310
900	250	255	261	266	271	277	282	287	293	298	303	308	314	319
1000	257	263	268	274	279	285	290	295	301	306	312	317	323	328
1100	264	270	276	281	287	293	298	304	309	315	321	326	332	338
1200	272	277	283	289	295	300	306	312	318	324	329	335	341	347
1300	279	285	291	297	302	308	315	321	326	332	338	345	350	356
1400	286	292	298	304	311	317	323	329	335	341	347	353	359	366
1500	293	299	306	312	319	325	331	337	343	350	356	362	369	375
1600	301	307	313	320	326	333	339	345	352	358	365	371	378	384
1700	308	314	321	328	334	341	347	354	360	367	374	380	387	393
1800	315	322	328	335	342	349	356	362	369	376	382	389	393	403
1900	322	329	336	343	350	357	364	371	378	384	391	398	405	412
2000	329	337	344	351	358	365	372	379	386	393	400	407	414	421
2100	337	344	351	358	366	373	380	387	395	402	409	407	424	431
2200	344	351	359	366	373	381	388	396	403	411	418	425	433	440
2300	351	359	366	374	381	389	396	404	412	419	427	434	442	449
2400	358	366	374	382	389	397	404	412	420	428	436	443	451	459

height (mm)

← width (mm)

**Remarks and surcharges**

- /// net prices - TAX should be added.
- /// standard colours of side guides and bottom beam are: 01 silver RAL 9006, 09B brown 8014\*, 22B ultra white 9016\*, 23B gray anthracite RAL 7016\* (\* - similar to colours with this number from the RAL palette).
- /// for an additional fee, varnishing in any colour from the RAL palette possible (extended lead time).

/// BOX varnishing in RAL colour	22,00 € / pc.
/// guides varnishing in RAL colour	13,75 € / set
/// bottom beam varnishing in RAL colour	8,25 € / pc.

Standard 90° SCREEN, 85 or 100 mm with spring control, fabric guidance in side guides

up to	700	800	900	1000	1100	1200	1300	1400	1500	1600	1700	1800	1900	2000
700	239	244	249	255	260	266	271	277	282	287	293	298	304	309
800	246	252	258	263	269	275	280	286	291	297	303	308	314	320
900	254	260	266	271	277	283	289	295	301	307	313	318	324	330
1000	262	268	274	280	286	292	298	304	310	316	322	328	335	341
1100	269	276	282	288	295	301	307	313	320	326	332	338	345	351
1200	277	283	290	296	303	309	316	323	329	336	342	349	355	362
1300	284	291	298	305	311	318	325	332	338	345	352	359	365	372
1400	292	299	306	313	320	327	334	341	348	355	362	369	376	383
1500	300	307	314	321	329	336	343	350	357	364	372	379	386	393
1600	308	315	322	330	337	344	352	359	367	374	381	389	396	404
1700	315	323	330	338	345	353	361	369	376	384	391	399	406	414
1800	323	331	338	346	354	362	370	378	385	393	401	409	414	425
1900	330	338	346	355	363	371	379	387	395	403	411	419	427	435
2000	338	346	355	363	371	379	388	396	404	413	421	429	438	446
2100	346	354	363	371	380	388	397	405	414	422	431	430	448	456
2200	353	362	371	379	388	397	406	414	423	432	440	449	458	467
2300	361	370	379	388	397	406	414	424	433	441	451	459	469	477
2400	369	378	387	396	405	414	424	433	442	451	460	470	479	488

height (mm)

← width (mm)

**Remarks and surcharges**

- net prices - TAX should be added.
- standard colours of side guides and bottom beam are: 01 silver RAL 9006, 09B brown 8014\*, 22B ultra white 9016\*, 23B gray anthracite RAL 7016\* (\* - similar to colours with this number from the RAL palette).
- for an additional fee, varnishing in any colour from the RAL palette possible (extended lead time).

BOX varnishing in RAL colour	22,00 € / pc.
guides varnishing in RAL colour	13,75 € / set
bottom beam varnishing in RAL colour	8,25 € / pc.

Standard 90° SCREEN, 85 or 100 mm with spring control, fabric guidance in side guides

up to	700	800	900	1000	1100	1200	1300	1400	1500	1600	1700	1800	1900	2000
700	248	255	262	269	275	282	289	296	303	309	316	323	330	337
800	257	264	272	279	286	294	301	308	315	322	330	337	344	351
900	266	274	282	289	297	304	312	320	328	335	343	350	358	366
1000	275	283	292	300	307	316	324	332	340	348	356	364	372	380
1100	284	293	301	310	319	327	335	343	352	361	369	377	386	395
1200	294	302	311	320	329	338	347	356	364	374	382	391	400	409
1300	302	312	321	330	339	349	358	368	377	386	395	405	414	423
1400	311	321	331	341	351	360	370	380	389	399	409	419	428	438
1500	321	331	341	351	361	371	381	391	402	412	422	432	442	452
1600	330	340	351	361	372	382	393	403	414	425	435	446	456	467
1700	339	350	360	372	382	393	405	416	426	438	448	460	470	481
1800	348	359	370	382	393	405	416	428	439	450	462	473	482	496
1900	356	368	380	392	404	416	428	439	451	463	475	487	499	510
2000	366	378	390	403	415	427	439	451	464	476	488	500	513	525
2100	375	387	400	413	426	438	451	463	476	489	501	505	527	539
2200	384	397	410	423	436	449	462	475	489	502	514	528	541	554
2300	393	406	420	433	447	460	474	487	501	514	528	541	555	568
2400	402	416	430	444	458	471	485	499	513	527	541	555	569	583

height (mm) ↑

← width (mm)

**Remarks and surcharges**

- net prices - TAX should be added.
- standard colours of side guides and bottom beam are: 01 silver RAL 9006, 09B brown 8014\*, 22B ultra white 9016\*, 23B gray anthracite RAL 7016\* (\* - similar to colours with this number from the RAL palette).
- for an additional fee, varnishing in any colour from the RAL palette possible (extended lead time).

BOB varnishing in RAL colour	22,00 € / pc.
guides varnishing in RAL colour	13,75 € / set
bottom beam varnishing in RAL colour	8,25 € / pc.

**Standard drives and controls**

Name	Net price
Standard wired drive	60,00 €
Standard radio drive	85,00 €
Standard 1-channel remote control	28,75 €
Standard 5-channel remote control	22,50 €
Standard 15-channel remote control	55,00 €
Standard 1-channel remote control with auto timer	50,00 €
Standard 15-channel remote control with auto timer	80,00 €

**Somfy – radio drives Sunilus SCR io – electronic limit switches with possibility of fabric tension**

Name	Torque	Speed	Net price
Sunilus SCR io 6/17	6 Nm	17 rev/min	187,50 €
Sunilus SCR io 10/17	10 Nm	17 rev/min	207,50 €
Sunilus SCR io 15/17	15 Nm	17 rev/min	227,50 €

**Somfy – radio drives MAESTRIA+ 50 io – universal drives to SCREEN shields with obstacle detection**

Name	Torque	Speed	Net price
Maestria+ 50 io 6/17	6 Nm	17 rev/min	210,00 €
Maestria+ 50 io 6/32	6 Nm	32 rev/min	225,00 €
Maestria+ 50 io 10/17	10 Nm	17 rev/min	227,50 €
Maestria+ 50 io 10/32	10 Nm	32 rev/min	245,00 €
Maestria+ 50 io 15/17	15 Nm	17 rev/min	240,00 €
Maestria+ 50 io 15/32	15 Nm	32 rev/min	257,50 €
Maestria+ 50 io 25/17	25 Nm	17 rev/min	266,25 €

**Somfy – IO control**

TAHOMA SWITCH - Internet installation manager IO & RTS	325,00 €
Set&Go io - starting tool for io installation	175,00 €
NiNa Timer remote control - individual and group control and time automatics	205,00 €
Situo 1 io Pure remote control	45,00 €
Situo 5 io Pure remote control	75,00 €
Smooove Origin io mural remote control with Pure frame	45,00 €
Chronis io - weekly autotimer	135,00 €
Sunis WireFree II io – solar sensor	125,00 €

**Somfy – wired drives**

Name	Torque	Speed	Net price
Solus 2 PA 6/12	6 Nm	12 rev/min	87,50 €
Solus 2 PA 10/12	10 Nm	12 rev/min	92,50 €
Solus 2 PA 15/12	15 Nm	12 rev/min	100,00 €
Solus 2 PA 20/12	20 Nm	12 rev/min	112,50 €
Maestria 50 WT 6/17 (drive with obstacle detection)	6 Nm	17 rev/min	160,00 €
Maestria 50 WT 10/17 (drive with obstacle detection)	10 Nm	17 rev/min	177,50 €
Maestria 50 WT 15/17 (drive with obstacle detection)	15 Nm	17 rev/min	192,50 €

**Solar drives**

Standard Solar drive RTS Wirefree 10 Nm ( drive + solar panel + battery)*	437,50 €
Remote control 1 (single-channel wall-mounted remote control with removing from the frame option)	30,00 €
Remote control 2 (two-channel wall-mounted remote control with removing from the frame option)	40,00 €
Power supply for standard solar drive	30,00 €
RTS Autosun SIMU 6/18 (drive + solar panel + battery), detection (from 650 mm width)	546,00 €
RTS Autosun SIMU 10/12 (drive + solar panel + battery), detection	572,00 €
Power supply for the SIMU solar drive	69,00 €
RTS Wirefree SOMFY 6/18 (drive + solar panel + battery), detection (from 650 mm width)	676,00 €
RTS Wirefree SOMFY 10/12 (drive + solar panel + battery), detection (from 650 mm width)	702,00 €
Power supply for the SOMFY solar drive	96,25 €

\* the motor can be used in boxes of the Premium variant: 85 mm - 90°; 95mm - 45° and 90°; 125mm - 45° and 90°. The maximum dimensions of the cover for the 85 mm 90° box are 2000 x 2200 mm, for other boxes 2500 x 3000 mm.

**Selve – wired drives (obstacle detection and gusts of wind)**

Name	Torque	Speed	Net price
SEZ 2/7	7 Nm	17 rev/min	192,50 €
SEZ 2/10	10 Nm	17 rev/min	200,00 €
SEZ 2/15	15 Nm	17 rev/min	205,00 €
SEZ 2/20	20 Nm	17 rev/min	212,50 €
SEZ 2/30	20 Nm	17 rev/min	220,00 €
SEZ 2/40	40 Nm	17 rev/min	275,00 €



**Selve – radio drives (obstacle detection and gusts of wind)**

Name	Torque	Speed	Net price
SEZ RC 2/7 ACTUATOR	7 Nm	17 rev/min	245,00 €
SEZ RC 2/10 ACTUATOR	10 Nm	17 rev/min	250,00 €
SEZ RC 2/15 ACTUATOR	15 Nm	17 rev/min	257,50 €
SEZ RC 2/20 ACTUATOR	20 Nm	17 rev/min	272,50 €
SEZ RC 2/30 ACTUATOR	30 Nm	17 rev/min	285,00 €
SEZ RC 2/40 ACTUATOR	40 Nm	17 rev/min	345,00 €

**Selve – control**

Name	Net price
Commeo Send 1 - manual 1-channel radio sender	85,00 €
Commeo Send 10 - manual 10-channel radio sender	125,00 €
Commeo Multi Send20 - manual 20-channel radio sender with auto timer	210,00 €
Commeo Wall Send - mural 1-channel radio sender	95,00 €
Commeo Light Send - radio sender with solar sensor for mounting on the window glass	145,00 €
Commeo Sensor WS - radio controller for sun shields, wind and solar sensor	270,00 €
Commeo Sensor WSRF -radio controller for sun shields, wind/ sun/ rain/ frost sensor	357,50 €
Selve Home Server2 - switchboard for controlling the radio drives with a smartphone, tablet or computer	462,50 €

**Elero – wired motors with obstacle detection (function of fabric protection)**

Name	Torque	Speed	Net price
SunTop/Z M7/23 RH	7 Nm	23 rev/min	176,25 €
SunTop/Z M12/23 RH	12 Nm	23 rev/min	193,75 €
SunTop/Z M10 RH	10 Nm	14 rev/min	163,75 €
SunTop/Z M20 RH	20 Nm	14 rev/min	183,75 €
SunTop/Z M30 RH	30 Nm	14 rev/min	250,00 €

**Elero – radio drives with obstacle detection (function of fabric protection)**

Name	Torque	Speed	Net price
SunTop/Z M7/23 - 868 RH	7 Nm	23 rev/min	241,25 €
SunTop/Z M12/23 - 868 RH	12 Nm	23 rev/min	257,50 €
SunTop/Z M10 - 868 RH	10 Nm	14 rev/min	230,00 €
SunTop/Z M20 - 868 RH	20 Nm	14 rev/min	245,00 €
SunTop/Z M30 - 868 RH	30 Nm	14 rev/min	257,50 €

**Elero – control**

Name	Net price
1-channel mural remote control SoloTel 2	46,25 €
1-channel remote control MonoTel 2	72,50 €
2-channel remote control LumeroTel 2 (additional 1 common channel) with manual / automatic on	77,50 €
5-channel remote control VarioTel 2 (additional 1 common channel) with manual / automatic on	90,00 €
10-channel remote control TempoTel 2 (additional 1 common channel) with manual / automatic on	118,75 €
15-channel remote control MultiTel 2 with display, manual / automatic on	118,75 €
MultiTec Touch-868 – 20-channel sender powered by 230 V	443,75 €
UniTec-868 surface-mounted sender, manual / automatic on	61,25 €
AstroTec-868 surface-mounted sender with clock, manual / automatic on	145,00 €
Aero-868 AC - wind and sun sensor, radio 230 V	260,00 €
Aeor-868 Plus – wind and sun sensor, radio, (double cell)	285,00 €
Sensero-868 AC - wind, sun and dusk sensor, radio 230 V	193,75 €
Sensero-868 AC PLUS - wind, sun, rain and dusk sensor, radio	308,75 €
Lumero-868 - sun sensor, radio	142,50 €
Lumo-868 - sun, dusk and shock sensor, radio	123,75 €
Centro Home mobile application	475,00 €
Mounting cable for Elero Revoline actuators	63,75 €
Mounting cable with Hirschmann plug	37,50 €

**wired control – control for wired drives**

Name	Net price
Flush-mounted push-button switch	8,75 €
Flush-mounted push-button switch with support (no need to hold the push-button)	10,00 €
Surface-mounted push-button switch	11,25 €
Surface-mounted push-button switch with support (no need to hold the push-button)	12,50 €
UNO SMOOVE Somfy push-button switch	16,25 €
DUO SMOOVE Somfy push-button switch	22,50 €
Key switch	48,75 €
R3 transmitter – allow to control with 3 drives simultaneously	62,00 €



# Order form – SCREEN

Surface-mounting  
Premium system

Fart Produkt Ltd. Limited partnership, Towarowa street 3, 87-100 Toruń  
tel. +48 56 623 55 77, fax. +48 56 649 57 23, export@fartprodukt.pl, www.fartprodukt.pl

TYPE OF CASSETTE MONTAGE *		TYPE OF SIDE GUIDE MONTAGE ***			DRIVE MONTAGE SIDE **		OUTPUT OF DRIVE CABLE *****		MOUNTING *****
<b>A</b>	<b>B</b>	FRONTAL	SIDE	PVC MOUNTING CLIP	L	R	A - side	B - back	
							C - without hole		[only 125 mm cassettes]

Ordinal	Cassette			Type of cassette montage *		Guidance *****				Total width [mm]	Total height [mm]	Quantity [pcs.]	Construction colour							Fabrics		Type of side guide montage ***					Motor	Drive montage side **		Output of drive cable *****							
						ZIP guidance	Bottom beam in side guides	Cable side guides	Mounting clip of cassette (only 125 mm cassettes)				white RAL 9016	creme RAL 9001	silver RAL 9006	brown RAL 8014	anthracite RAL 7016	black gray RAL 7021	varnishing RAL (extra charge)	Colour of fabric	Back *****	Standard side guide		PD side guide				L	R	A	B	C					
	Frontal	Side	Frontal	Side	Pvc clip					Distance of PD side guide																											
	45° □	45° □	45° □																																		
	90° □	90° □	90° □																																		
	45° □	45° □	45° □																																		
	90° □	90° □	90° □																																		
	45° □	45° □	45° □																																		
	90° □	90° □	90° □																																		
	45° □	45° □	45° □																																		
	90° □	90° □	90° □																																		
	45° □	45° □	45° □																																		
	90° □	90° □	90° □																																		
	45° □	45° □	45° □																																		
	90° □	90° □	90° □																																		
	45° □	45° □	45° □																																		
	90° □	90° □	90° □																																		

**CAUTION.** In some of the screen fabrics, the front and back side of the fabric differ in appearance and light transmission properties. In the pattern, these fabrics are presented by 2 samples: "front" and "back". As a standard, the "front" of the fabric is on the outside of the building and the "back" is by the room side. If you want to "invert" the sides, please select the "back" option. \*\*\*\*\*

**CAUTION.** The distance of the PD guide can be applied only in single shutters, it is not possible to use distances in sets created in a one common box. \*\*\*

COMMENTS / DRAWINGS FROM WITHIN

Order no	Transport
Order date	Lead time
Stamp and signature of commissioning party	

**DIMENSIONING**

By installation in a recess, the measurement should be taken in 3 places and the **smallest value** should be specified in the order.

Allowing for a slight mounting clearance should be taken into account.



# Order form – SCREEN

Recessed montage, ZIP guidance  
**Partial** building-over of the side guide  
 Premium system

Fart Produkt Ltd. Limited partnership, Towarowa street 3, 87-100 Toruń  
 tel. +48 56 623 55 77, fax. +48 56 649 57 23, export@fartprodukt.pl, www.fartprodukt.pl

TYPE OF SIDE GUIDE MONTAGE *			DRIVE MONTAGE SIDE **		OUTPUT OF DRIVE CABLE ***		MOUNTING ****
FRONTAL 	SIDE 	PVC MOUNTING CLIP 	L 	R 	A – side 	B – back 	CLIP OF CASSETTE 
			(view from within)		C – without hole		[only 125 mm cassettes]

Ordinal	Cassette		Insulating of the cassette - bracket + guide distance (10 mm on the back)	**** Mounting clip of cassette [only 125 mm cassettes]	Bracket 20 mm (from front)	Total width [mm]	Total height [mm]	Quantity [pcs.]	Construction colour								Fabrics		Type of side guide montage *			Spacer profile	Motor	** Drive montage side (from within)		**** Output of drive cable														
	90°								white RAL 9016	creme RAL 9001	silver RAL 9006	brown RAL 8014	anthracite RAL 7016	black gray RAL 7021	varnishing RAL (extra charge)	Colour of fabric	***** Back	Frontal	Side	Pvc clip	L			R	A	B	C													
	105 [mm]	125 [mm]																																						

**CAUTION.** In some of the screen fabrics, the front and back side of the fabric differ in appearance and light transmission properties. In the pattern, these fabrics are presented by 2 samples: "front" and "back". As a standard, the "front" of the fabric is on the outside of the building and the "back" is by the room side. If you want to "invert" the sides, please select the "back" option. \*\*\*\*\*

Order no	Transport
Order date	Lead time
Stamp and signature of commissioning party	

DIMENSIONING

By installation in a recess, the measurement should be taken in 3 places and the **smallest value** should be specified in the order.

Allowing for a slight mounting clearance should be taken into account.

COMMENTS / DRAWINGS FROM WITHIN







# Order form – SCREEN

Opoterm, top-mounted box  
Standard system

Fart Produkt Ltd. Limited partnership, Towarowa street 3, 87-100 Toruń  
tel. +48 56 623 55 77, fax. +48 56 649 57 23, export@fartprodukt.pl, www.fartprodukt.pl

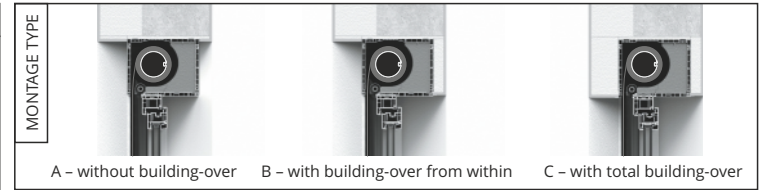
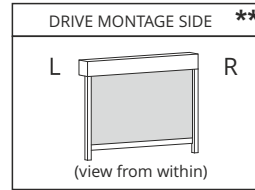

Ordinal	Cassette			Guidance		Total width [mm]	Total height [mm]	Quantity [pcs.]	Bottom beam colour	Kolor skrzynki			Revision placement		Fabrics		Motor	** Drive montage side (from within)		Type of adaptive profile
	170 [mm]	210 [mm]	240 [mm]	ZIP guidance	Bottom beam in side guides					Frontal profiles		Revision flap colour	From the forehead	From underneath	Colour of fabric	***** Back		L	R	
										External	Internal									

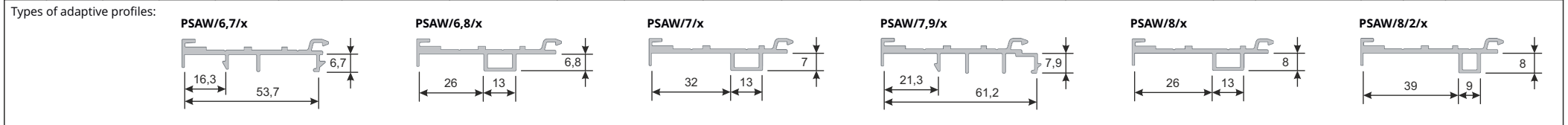

<p><b>CAUTION.</b> In some of the screen fabrics, the front and back side of the fabric differ in appearance and light transmission properties. In the pattern, these fabrics are presented by 2 samples: "front" and "back". As a standard, the "front" of the fabric is on the outside of the building and the "back" is by the room side.</p> <p>If you want to "invert" the sides, please select the "back" option. *****</p>	Order no	Transport	<p><b>DIMENSIONING</b></p> <p>By top mounted roller shutter, the width of the shield is equal to the width of the window frame.</p> <p>To the height of the frame the height of appropriate roller shutter box should be added.</p>
	Order date	Lead time	
	Stamp and signature of commissioning party		

COMMENTS / DRAWINGS FROM WITHIN



Fart Produkt Ltd. Limited partnership, Towarowa street 3, 87-100 Toruń  
 tel. +48 56 623 55 77, fax. +48 56 649 57 23, export@fartprodukt.pl, www.fartprodukt.pl

# Order form – SCREEN

Surface-mounting  
 Basic system

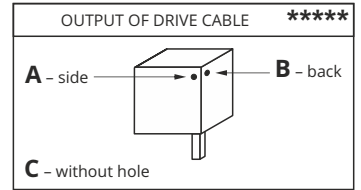
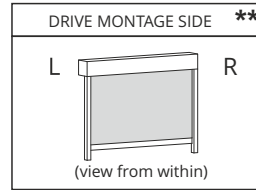
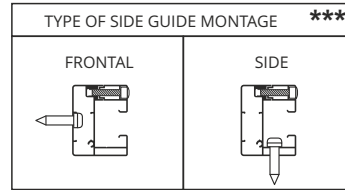
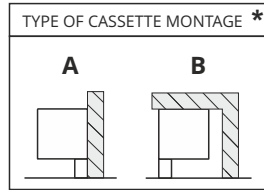

Ordinal	Cassette			* Type of cassette montage		* Guidance		Total width [mm]	Total height [mm]	Quantity [pcs.]	Construction colour					Fabrics		*** Type of side guide montage		Motor	** Drive montage side (from within)		***** Output of drive cable																			
	90°			A	B	ZIP guidance	Bottom beam in side guides				01 silver RAL 9006	09B brown 8014*	22B ultra white 9016*	23B anthracite gray 7016*	varnishing RAL (extra charge)	Colour of fabric	Back *****	Frontal	Side		L	R	A	B	C																	
	85 [mm]	100 [mm]	120 [mm]																																							

**CAUTION.** In some of the screen fabrics, the front and back side of the fabric differ in appearance and light transmission properties. In the pattern, these fabrics are presented by 2 samples: "front" and "back". As a standard, the "front" of the fabric is on the outside of the building and the "back" is by the room side. If you want to "invert" the sides, please select the "back" option. \*\*\*\*\*

COMMENTS / DRAWINGS FROM WITHIN

Order no	Transport
Order date	Lead time
Stamp and signature of commissioning party	

DIMENSIONING

By installation in a recess, the measurement should be taken in 3 places and the **smallest value** should be specified in the order.

Allowing for a slight mounting clearance should be taken into account.



Fart Produkt Ltd. Limited partnership, Towarowa street 3, 87-100 Toruń  
 tel. +48 56 623 55 77, fax. +48 56 649 57 23, export@fartprodukt.pl, www.fartprodukt.pl

# Order form – SCREEN

Surface-mounting  
 Basic SPR System

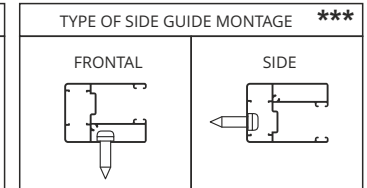
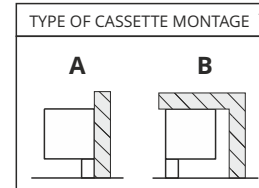

Ordinal	Cassette		Type of cassette montage **		Total width [mm]	Total height [mm]	Quantity [pcs.]	Construction colour (* - similar to colours with this number from the RAL palette)					Fabrics			Type of side guide montage ***	
	90°		A	B				01 silver RAL 9006	09B brown 8014*	22B ultra white 9016*	23B anthracite gray 7016*	varnishing RAL (extra chargé)	Colour of fabric	Back	Frontal	Side	
	85 [mm]	100 [mm]															

**CAUTION.** In some of the screen fabrics, the front and back side of the fabric differ in appearance and light transmission properties. In the pattern, these fabrics are presented by 2 samples: "front" and "back". As a standard, the "front" of the fabric is on the outside of the building and the "back" is by the room side. If you want to "invert" the sides, please select the "back" option. \*\*\*\*\*

Order no	Transport
Order date	Lead time
Stamp and signature of commissioning party	

**DIMENSIONING**

By installation in a recess, the measurement should be taken in 3 places and the **smallest value** should be specified in the order.

Allowing for a slight mounting clearance should be taken into account.

COMMENTS / DRAWINGS FROM WITHIN



### General Provisions

1. General Terms and Conditions of Sale shall apply to the sale of products of the Fart Produkt sp. z o.o. sp.k. company having its registered office in Toruń at ul. Towarowa 3, entered into the National Court Register under the number 0000615850.
2. The sale shall be made to the economic operators cooperating with Fart-Produkt, hereinafter referred to as Trading Partners.
3. Price list does not constitute an offer within the meaning of the Civil Code.
4. Trading Partner is a separate, economic operator independent of the Fart-Produkt.
5. Trading Partners operate in their own name and on their own account.
6. Trading Partner may use trademarks of Fart-Produkt only with the consent of Fart-Produkt or only for the purpose of identifying Fart-Produkt as the manufacturer of a product.
7. All trade information obtained from Fart-Produkt shall be confidential and should not be disclosed by Trading Partner to any third parties.
8. Business Days within the meaning of this Terms and Conditions of Sale shall mean days from Monday to Friday excluding public holidays.

### Obligations and Liabilities of Trading Partner

1. Having relevant expertise for the purpose of optimal selection of products from the wide range of products offered by Fart-Produkt.
2. Having relevant expertise for the purpose of proper assembly of products from the wide range of products offered by Fart-Produkt.
3. Providing customers with true information about products from the wide range of products offered by Fart-Produkt.
4. Displaying advertising materials and relevant information about Fart-Produkt as the manufacturer of the products.
5. Providing services during the period.
6. Providing post- services according to individual agreements with customers.
7. Handling of customer complaints pertaining to the products offered by Fart-Produkt, in accordance with the complaints procedure.
8. Protecting good reputation and corporate image of Fart-Produkt by providing reliable service, proper assembly as well as providing maintenance services on products from the wide range of products offered by Fart-Produkt.
9. Ensuring that proper storage conditions will be maintained for products delivered by Fart-Produkt, including proper display of products offered by Fart-Produkt.

### Prices

1. Prices of products offered by Fart-Produkt are indicated in price list valid on a given date. Prices quoted are net prices. VAT should be added to the given prices at the rate applying on the date when the tax obligation arises.
2. Prices indicated in price lists of Fart-Produkt are expressed in Euro.
3. Prices indicated in price lists of Fart-Produkt are recommended retail prices, on which discount will apply for Trading Partner. Discounts shall be settled individually.
4. Prices indicated in price lists do not include assembly.
5. Fart-Produkt reserves the right to modify the price list. Any modification to the price list will be communicated to Trading Partners when published on the site [www.fartprodukt.pl](http://www.fartprodukt.pl), via e-mail and by sales representatives of Fart-Produkt.

### Orders

1. Trading Partner shall place Orders in writing using order forms prepared by Fart-Produkt.

2. Order forms shall be delivered together with price lists and are available on the site [www.fartprodukt.pl](http://www.fartprodukt.pl).
3. Orders can be placed via fax or internet. By placing an order Trading Partner accepts the General Terms and Conditions of Sale and Trading Partner shall bear full responsibility for the content of order, which he has placed.
4. Orders placed in other form than by order forms will extend the order completion period and Fart-Produkt shall not be responsible for interpretation of data included in such orders.
5. Any modifications of orders require written form and they will extend the order completion period.
6. If an order is in progress the costs related to any modification of such order will be borne by Trading Partner.
7. Non-standard orders as well as orders under which lacquering of elements of finished product is required will extend the order completion period to 3 weeks.
8. Placing an order is considered as acceptance of the General Terms and Conditions of Sale.

### Terms of payment

1. Trading Partner is obliged to pay for ordered and purchased products on the date indicated in the invoice. The payment deadline shall be the date on which bank account of Fart-Produkt has been credited.
2. The terms, like: advance payments, form and the payment deadline will be determined individually for every Trading Partner.
3. If Trading Partner exceeds the payment deadline it may result in charging statutory interest for late payment by Fart-Produkt, suspension of execution of successive orders, refusal to deliver ordered products, modifying the terms of payment.
4. In case the payment deadline has been exceeded and compulsory enforcement of payment due to Fart-Produkt by debt collection agency is necessary, then Trading Partner authorises Fart-Produkt to charge Trading Partner with costs related to recovery of due amount.

### Warranty

1. Fart-Produkt shall provide a 24-month warranty for delivered products to Trading Partner.
2. The warranty period shall commence on the date of issuing an invoice to Trading Partner.
3. Warranty provided by Fart-Produkt shall be valid only with a relevant document confirming the purchase of the product i.e. VAT invoice or receipt.
4. If damage is discovered which could not be objectively noticed externally over delivery, the Trade Partner should report the disclosed damage immediately, but no later than within 7 days from the date of delivery.
5. Upon delivery, the Trade Partner is obliged to check the consistency of the delivery with the invoice or WZ document. Any contradictions and failings should be reported by the Trade Partner immediately, but not later than within 7 days from the date of delivery.
6. Trading Partner shall act as the Guarantor unto customer.
7. The Guarantor performs his duties at his headquarters, in the place of business. The customer is obliged to transport the goods subject by the warranty notification to the place specified in point 1 of the General Provisions of these General Sales Conditions. If the Guarantor makes regular deliveries to the customer, the goods subjected by the complaint may be picked up from the customer's point, after prior arrangement of such a possibility.
8. When delivering the goods subjected by the complaint, the customer is obliged to properly secure and pack it. The customer bears the costs for any damage resulting on the score of unsecured goods.
9. The Guarantor does not bear the costs of

assembly, disassembly, commuting, or any other costs directly or indirectly related to the assembly or disassembly of the goods subjected by the warranty.

10. The Customer's rights under the Warranty are limited only to the defective part of the goods, unless it cannot be separated from the rest of the goods.

11. Assembly of products of Fart-Produkt shall be performed by dedicated and trained assembly teams, otherwise the warranty rights shall be deemed null and void.

12. The warranty does not cover:

- damage caused by Trading Partner or persons for whom Trading Partner shall be responsible as well as damage caused by third parties.
  - natural wear and tear of the products, incorrect assembly, incorrect start-up, inappropriate use of the product, impact of external factors.
  - discoloration and other changes in the surface properties of elements caused by the influence of atmospheric factors as well as differences in the shades of colours between template and a real finished product.
  - defects of indentations, scratches, damages, if they resulted from inappropriate transport of products by Trading Partner.
  - damages resulting from random events (fire, flood, etc.)
  - damages resulting from improper storage of products by Trading Partner.
  - oversized products ordered on special request of Trading Partner.
13. Trading Partner shall bear the costs of transport to the place of complaint.
  14. In case of unjustified call for expert of Fart-Produkt to the place of complaint, Fart-Produkt shall charge Trading Partner with the costs incurred.
  15. Interference in visual elements of products, i.e. removing stickers, logo, rating plates shall result in the loss of warranty rights.
  16. Trading Partner shall lose the warranty rights in case Trading Partner or any third parties will make any modifications or unauthorised repairs of the products.
  17. Guarantee will cover damages caused by courier company only in case of writing a proper damage protocol in the presence of the courier by Trading Partner.

### Final Provisions

1. Any disputes which may arise between Fart-Produkt and Trading Partner, if they cannot be settled amicably, will be dealt with by common courts, with jurisdiction over the registered office of Fart-Produkt.
2. Any matters not provided for in the provisions of Cooperation Agreement or the General Terms and Conditions of Sale shall be governed by the Civil Code.

### All rights reserved.

The property rights to texts, drawings, photos and all other information published in this price list belong to Fart Produkt Ltd. limited partnership, Towarowa street 3, 87-100 Toruń. It is forbidden to use, duplicate, distribute or modify the submitted graphic materials in a manner other than specified in the contract with Fart Produkt Ltd. limited partnership, Towarowa street 3, 87-100 Toruń. Fart Produkt Ltd. limited partnership, Towarowa street 3, 87-100 Toruń reserves the right to withdraw consent to the use, reproduction, distribution or modification of received graphic materials.

Fart Produkt Ltd. Limited partnership,  
Towarowa street 3, 87-100 Toruń,  
tel. 56 623 55 77, fax. 56 649 57 23,  
[www.fartprodukt.pl](http://www.fartprodukt.pl), [export@fartprodukt.pl](mailto:export@fartprodukt.pl)

Towarowa street 3  
87 - 100 Toruń  
tel. + 48 56 623 55 77  
fax. + 48 56 649 57 23  
[www.fartprodukt.pl](http://www.fartprodukt.pl)  
e-mail: [export@fartprodukt.pl](mailto:export@fartprodukt.pl)

